



VOLUME V

APRIL 1971

NUMBER 2

PUBLISHED QUARTERLY BY

ARK-LA-TEX GENEALOGICAL ASSOCIATION, INC.

P. O. BOX 71
SHREVEPORT, LOUISIANA
71102

ARK-LA-TEX GENEALOGICAL ASSOCIATION

P. O. Box 71

Shreveport, Louisiana 71102

Organized 1955

Publisher: THE GENIE Since 1967

OFFICERS for 1971 - 1972

President: E. M. Tipton, Rt. 1, Box 403-D, Bossier City, La. 71010, Tel.423-6983
1st Vice Pres: Mrs. Frank J. Slimer, Jr., Chairman Program & Publicity Committees
2nd Vice Pres.& Treas: Dr. T. V. Holmes, Jr., Chairman Finance & Budget Committee
Recording Secretary: Mrs. James T. Evans, Member of Publications Committee
Corresponding Secretary: Mrs. Roland E. Moore, Chairman Membership Committee
Editor of The Genie: Mrs. Ennis M. Tipton, Chairman Publications Committee

TRUSTEES

Mr. Benjamin E. Achee, Jr., Past President, Member Program & Finance Committees
Mrs. H. N. Barnett, Past President, Class Director for Special Instruction
Mrs. Sam J. Nation, Charter Member, Chairman Northwest Louisiana Record Committee
Mrs. Margery Wright, Genealogy Librarian, Member Program & Publications Committees
Ex-Officio Member Board of Directors: Mr. Richard T. Colquette, Past President

NOTE: The Board of Directors is composed of all officers & trustees listed above.

All genealogical material of this Association is deposited in the Genealogy Dept.,
Shreve Memorial Library, Archives of the 4th Congressional District of Louisiana.

REGULAR MEETINGS: Second Saturday of each month, 2:00 to 4:00 p.m.
Shreve Memorial Library, 400 Edwards St., Shreveport, La.

BOARD MEETINGS: First Sunday of each month, 2:30 to 4:30 p.m.
E. M. Tipton residence, Highway 71 South, Bossier City, La.

MEMBERSHIP DUES: Per Calendar Year, January 1 to December 31, \$3.00 for 1971

Please use form on last page this issue for submitting dues & membership applications.

THE GENIE: Published quarterly, January, April, July & October each year.

All members receive four issues of The Genie each year. Queries are published free.
Single copies of The Genie to non-members \$1.50 postpaid. Ark-La-Tex Genealogical
Association assumes no responsibility for correctness of statements or opinions ex-
pressed by contributors to The Genie, and all material is submitted for publication
by members of this Association or its readers. Permission to reprint any material
published in The Genie must be obtained in writing from the Editor. Members are
urged to submit material for publication: Family Records, Bible Records, Cemetery
Records, Queries, and any other material of general genealogical interest.

SPECIAL EDITION OF THE GENIE: August 1971, 140 pages, indexed, 8½x11", paper back,
contains information on research facilities of Ark-La-Tex area, 98 five-generation
ancestor charts of members, and other data. Published as a service to genealogists
and libraries, as well as individual searchers who may find "missing links" in it.
Reports show many valuable contacts already made from this book. \$2.50 postpaid.

THE GENIE INVITES EXCHANGE OF PERIODICALS WITH OTHER GENEALOGICAL ORGANIZATIONS.

Please address all correspondence to P. O. Box 71, Shreveport, Louisiana 71102.

FIFTH ANNUAL WORKSHOP
of the
ARK-LA-TEX GENEALOGICAL ASSOCIATION

Saturday, 15 May 1971
9:00 a.m. - 5:00 p.m.

Holiday Inn, Downtown Shreveport-Bossier City
I-20 at Hamilton Road, Bossier City, La.

Lecturer

MILTON RUBINCAM

Mr. Rubincam will lecture on "Pitfalls in Genealogical Research", "Evaluation of Genealogical Materials", related subjects, and qualifications of Certified Genealogists, American Lineage Specialists and Record Searchers. If time permits, he will answer written questions submitted prior to question and answer period.

- 8:00-9:00 a.m. Registration (See details below - Registration forms on last page)
- 9:00 a.m. Call to Order by E. M. Tipton, President
Ben Achee, Master of Ceremonies for morning session.
Invocation by Rev. Eugene Spruell, Pastor, Western Hills Baptist Church, Shreveport, Louisiana. He is also a genealogist.
Pledge of Allegiance to The Flag
Welcome
Response by Mary Agnes Slimer
Introductions
- 9:30 a.m. LECTURE by MILTON RUBINCAM
- 10:30 a.m. Coffee Break
- 10:45 a.m. LECTURE by MILTON RUBINCAM
- 11:45 a.m. Lunch - Dutch Treat - Holiday Inn Buffet
- 1:15 p.m. Call to Order by Bill Randolph, M.C. for afternoon session
- 1:20 p.m. LECTURE by MILTON RUBINCAM
- 2:20 p.m. Awarding of Door Prizes
Introduction of Distinguished Guests
Coffee Break
- 3:00 p.m. LECTURE by MILTON RUBINCAM
- 3:30 p.m. Question and Answer Period
- 4:00 p.m. Announcements and Adjournment
- 4:15 p.m. Social Hour - Refreshments - Room Closes at 5:00 p.m.

* * * * *

See biographical data on Mr. Milton Rubincam. Registration forms on last page. Please get your registrations in as soon as possible. Pre-registration is not required but will be greatly appreciated to avoid last minute rush. Be sure to mail your registrations to Ark-La-Tex Genealogical Association, P.O. Box 71, Shreveport, La., 71102, in time to be delivered by Thursday, 13 April 1971. The registration desk closes at 9:00 a.m., 15 May, so registration committee may attend meeting, however, late arrivals will be taken care of just inside the door of the meeting room. Holiday Inn, where this meeting is held, is recommended to all needing overnight accommodations. Make reservations well in advance.

MILTON RUBINCAM

Milton Rubincam was born in Philadelphia, Pennsylvania, 26 March 1909; paternally of Pennsylvania-German and English ancestry, and maternally of Canadian, English and Scottish ancestry. Shreveport historians and genealogists will be interested to know that he is a relative of Captain Henry Miller Shreve.

Mr. Rubincam studied Journalism at Temple University, Philadelphia, Pa., 1930-32, and Editorial work at The American University, Washington, D.C., 1941-42. He has been in Government service since 1935 and at present is Chief of Procedures and Instructions Section, Foreign Commercial Services Staff, Bureau of International Commerce, Department of Commerce, Washington, D. C.

He began genealogical research at the age of 15, in 1924, and a brief, incomplete summary of his activities in the field of genealogy follows.

- President: National Genealogical Society, 1945-48.
Pennsylvania Historical Junto, Washington, D. C., 1947-54.
The American Society of Genealogists, 1961-64.
- Chairman: Board for Certification of Genealogists, since 1964.
- Editor: National Genealogical Society Quarterly, 1957-62.
Genealogical Research: Methods and Sources (Published in 1960 by The American Society of Genealogists; now in its 4th printing.)
- Fellow: The American Society of Genealogists.
National Genealogical Society.
The Genealogical Society of Pennsylvania.
- Member: Pennsylvania German Society
Society of the Descendants of the Colonial Clergy
Columbia Historical Society, Washington, D. C.
Ohio Genealogical Society
Ontario Genealogical Society
York Pioneer and Historical Society, Toronto, Ontario
- and others -
- Lecturer: The Institute of Genealogical Research, The American University,
Washington, D. C., since 1950.
The Institute of Genealogy, Samford University, Birmingham,
Alabama, since 1962.
- Author: Of numerous articles in historical and genealogical periodicals published in the United States, Canada, England and Germany.
- Participated in the World Conference on Records and Seminars on Genealogy, Salt Lake City, Utah, August 1969.
- Participated in the Seminars conducted by the Ontario Genealogical Society, Waterloo, Ontario, Canada, 1964-66.

* * * * *

This is the man who will lecture at our Fifth Annual Workshop, 15 May 1971.

Don't miss hearing him on his first visit to the Ark-La-Tex area. The program for the meeting and other details follow.

REVIEW

Regular meetings for January, February and March were well attended. See pages 6, 7, 8 & 9 for "Guide to Materials Available in the Genealogy Room of Shreve Memorial Library", subject of the series of lectures presented at these meetings.

Our membership now totals 190, including 16 who have not paid 1971 dues, but we hope they will get them in before March 31. A complete roster will be published in the July Genie. Our goal is to have 200 members by that time.

Response to the plea for Queries has been most generous. Our little "Information Please" has recovered from his malnutrition, is growing like a weed, with an insatiable appetite, so don't fail to send in your queries for future issues. Our Exchange List is being revised and enlarged, and with the increase in circulation your Queries will reach many more places and people. This means you will have a much greater potential for success with all your Queries.

Several members sent the source of the little book on filing. WHO'S WHERE IN YOUR GENEALOGICAL RECORDS - A Filing & Finding System by J. R. Gobble, is available from Everton Publishers, Box 368, Logan, Utah 84321, for \$1.50 postpaid. WHAT TO SAY IN YOUR GENEALOGICAL LETTERS - Do's & Don'ts in Genealogical Correspondence by J. R. Gobble is also available from Everton at the same price.

The Beginner's Class in Genealogical Research started at Shreve Memorial Library with 17 enrolled on 1 March, to run for eight weeks, 7:00 to 9:00 p.m. on Monday evenings. Mrs. Margery Wright and Benn Achee are doing an excellent job of teaching the basic techniques of research, and we hope to schedule another class later this year to cover more advanced research.

Printed copies of the new Charter and By-Laws are available to members who request them. Copies of "the mini genie" enclosed with this issue are for you to pass on to anyone interested in our Association, or to post on the bulletin board of your library or meeting room. Do your friends a favor and let them know what we are doing.

Plans for the Workshop are going well. See page 3 & 4 for the program and data on Mr. Milton Rubincam who will conduct the lectures. Registration forms are on page 49. Please send your registrations in early.

PREVIEW

The educational programs will continue for our regular meetings. Fern Ainsworth will give a demonstrated lecture on "Migration Trails" April 10. On May 8, final details for the Workshop on May 15, with a lecture to follow the business session. "Microfilm Records" will be presented on June 12.

Members in the Shreveport area are doing outstanding work in copying records from microfilm, cemeteries, old Bibles, etc., for publication, but we need data from other areas. Unpublished records from southwestern Arkansas and northeast Texas are badly needed.

The next issue of The Genie is due out 1 July 1971. P L E A S E send in your material for publication as soon as possible, no later than June 1st except for last minute announcements. I don't like setting a deadline, but it is necessary to have adequate time to edit, type, print and assemble The Genie for mailing, and it is unfair to all of you to try to rush it too much. Get your queries in so I'll have time to do a better job on them than I have in this issue. Let's keep our section "Information Please" up to five or six pages every issue. Your cooperation will be most sincerely appreciated. It's your Genie, help make it a good one.

BE SURE TO GET YOUR MATERIAL FOR PUBLICATION IN THE JULY GENIE IN BY JUNE 1st.

GUIDE TO MATERIALS AVAILABLE IN THE GENEALOGY ROOM OF SHREVE MEMORIAL LIBRARY

Ema Lee Tipton

What you don't know may not kill you, but can certainly create difficulties, especially in genealogical research, and specifically in libraries. If you are too timid to ask questions of the librarian or don't know what questions to ask, don't feel lonesome. Just join the club - the searchers who set out full of hope and return home empty handed so many times; and weep with me for the lost years I have blundered away in bewilderment at the library.

I could always find the microfilm, sometimes an unused reader, state groups of books, but seldom a book of any help to me. I didn't know what that little cabinet at the end of the locked cases was for and if I'd ever been curious enough to look inside, would not have understood the data on the cards. Seeing others so busily reading and copying from books which apparently had extensive information on their families, I finally decided all mine were so unimportant that little had ever been published about them and I would just have to dig the records out of Archives and courthouses in Alabama, Arkansas, the Carolinas, Georgia, Louisiana, Mississippi, Oklahoma, Tennessee, Texas and Virginia - and that's a lot of courthouses. I'd scrimp, save and plan all year for a crowded two-week trip each summer and kept hoping for a miracle to speed things up because I knew I'd never live long enough to complete the job this way.

Then the miracle happened! Mary Agnes Slimer, our new program chairman, set up a year of educational programs for our regular meeting, to start with a series of lectures on "Materials Available in the Genealogy Room of Shreve Memorial Library", conducted by Margery Wright and Ben Achee. Attendance at our January and February meetings was so unexpectedly great there was not enough handout material to go around, so I took none. I listened intently to the lectures, but am not very audile, much of what I hear just goes in one ear and out the other, and without the guide to follow, missed many details of the lectures.

When I received a copy of this material to prepare masters for reprinting, I just flipped! Margery Wright had done such a thorough job of diagramming the Genealogy Room, explaining the numbering system and arrangement of books, the Card Catalog, and other finding aids that a child could understand it. Next day at the library, I found three books with chapters totalling 313 pages on a family I felt must surely be "the least of these" referred to in the Bible because they seemed so little known outside their own communities. The Library Guide is the miracle I was hoping for. I'm sure now to find much information on many of my families, right here at home.

Some of you already know how to find everything at the library, but this is for the vast silent majority just like me who don't know. Recently I had the privilege of showing Booth's Confederate Records to a Shreveport searcher who had never heard of them before. She found her grandfather's Confederate records, height, color of his eyes and hair, age and residence, and on the same page, records of his brothers who also served in the Confederate Army from Louisiana. The Card Catalog would have told her where to look years ago, but, like me, she didn't know what it was for or how to use it, and didn't understand the numbering system for the books.

"A Guide to Materials in the Genealogy Room of Shreve Memorial Library", by Margery Wright, is published on the next three pages. Put this Guide in your copy book so you will have it each time you go to the library. Free copies of this valuable Guide, supplied by the Ark-La-Tex Genealogical Association, are now available at the librarian's desk for all who do research in this library. All our members are urged to publicize the availability of the Guide by telling others about it at every opportunity.

A GUIDE TO MATERIALS IN THE GENEALOGY ROOM OF SHREVE MEMORIAL LIBRARY

THE CARD CATALOG

The Card Catalog is to the library what an index is to a book for it shows what material the library has and where to find it. The Card Catalog indicates the number of the book, and the index indicates the number of the page.

The Card Catalog is arranged alphabetically. Each entry is made on a separate card so that new cards may be inserted each time a book is added to the library.

Since the Card Catalog shows whether the library has a particular book, or books by a certain author, or books on a special subject, we can expect to find three important kinds of cards in the Catalog: Author, Title, and Subject cards.

SAMPLE OF CARDS

Author Card

Gen.	King, Estelle Stewart
975.5	Wills, administrations and marriages of Fauquier County, Virginia. Beverly Hills, Calif. Author, 1959.
	171 p.

Title Card

Gen.	Wills, administrations and marriages of Fauquier County, Virginia.
975.5	King, Estelle Stewart
	Wills, administrations and marriages of Fauquier County, Virginia. Beverly Hills, Calif. Author, 1959.
	171 p.

Subject Card (The heading on this card will be typed in RED.)

Gen.	Virginia - Genealogy
975.5	King, Estelle Stewart
	Wills, administrations and marriages of Fauquier County, Virginia. Beverly Hills, Calif. Author, 1959.
	171 p.

If you are looking at an Author Card and are uncertain if the book would be of help to you, LOOK AT THE BACK OF THE CARD. Typed on the back, in red, you will find a list of the Subject Cards on that book. That list of Subject Cards may help you in deciding if the book would be of help to you.

In the library here, we try to make two Subject Cards on each book, i.e., one card to give the state (Alabama - Genealogy) and one if possible to give the county (Dallas County, Alabama). If the book is a family history we give only the two main lines in the book, except in rare instances.

Green banded cards, marked V.F. means that the material is in the Vertical File, not on the shelf.

"Locked Case" or "Larkin Edwards" on a card under the call number means that the book is not on the open shelf, and you must ask the librarian about using that book. These are the rare, irreplaceable, often very old and very fragile books which must be handled with extreme care.

Books in the library are arranged by number starting with 000.00 and proceeding through 999.99. The number denotes the category the books have been placed in. Every book in each category has the same number. Thus, all books on Georgia will be shelved together since they all have the same number.

When you check the Card Catalog, make a note of the number of each book you are interested in since that will help you find the books you want.

THE NUMBERING SYSTEM

GENERAL REFERENCE BOOKS

000-099	Bibliographies	929.22	Specific Family Histories
100-299	Not genealogy	929.3	Compilations of Specific Family Histories
300-399	Military Rosters		
	Pension Indexes	929.4	Migrations of Ethnic Groups and Passenger Lists
	Patriotic Organizations		
400-699	Not genealogy	929.6-)	Heraldry
700-799	Historic Buildings	929.8)	
800-899	Not genealogy	942	England
910-915	Atlases	973.082	American Territorial Papers
929	Lineage Books	973.3	Revolutionary War
929.2	General Family Histories	973.6	Civil War

BOOKS ON INDIVIDUAL STATES

974.1	Maine	976.1	Alabama
974.2	New Hampshire	976.2	Mississippi
974.3	Vermont	976.3	Louisiana
974.4	Massachusetts	976.4	Texas
974.5	Rhode Island	976.5	
974.6	Connecticut	976.6	Oklahoma
974.7	New York	976.7	Arkansas
974.8	Pennsylvania	976.8	Tennessee
974.9	New Jersey	976.9	Kentucky
975.1	Delaware	977.1	Ohio
975.2	Maryland	977.2	Indiana
975.3	District of Columbia	977.3	Illinois
975.4	West Virginia	977.4	Michigan
975.5	Virginia	977.5	Wisconsin
975.6	North Carolina	977.6	Minnesota
975.7	South Carolina	977.7	Iowa
975.8	Georgia	977.8	Missouri

DIAGRAM OF THE FLOOR PLAN OF THE GENEALOGY ROOM, SHREVE MEMORIAL LIBRARY

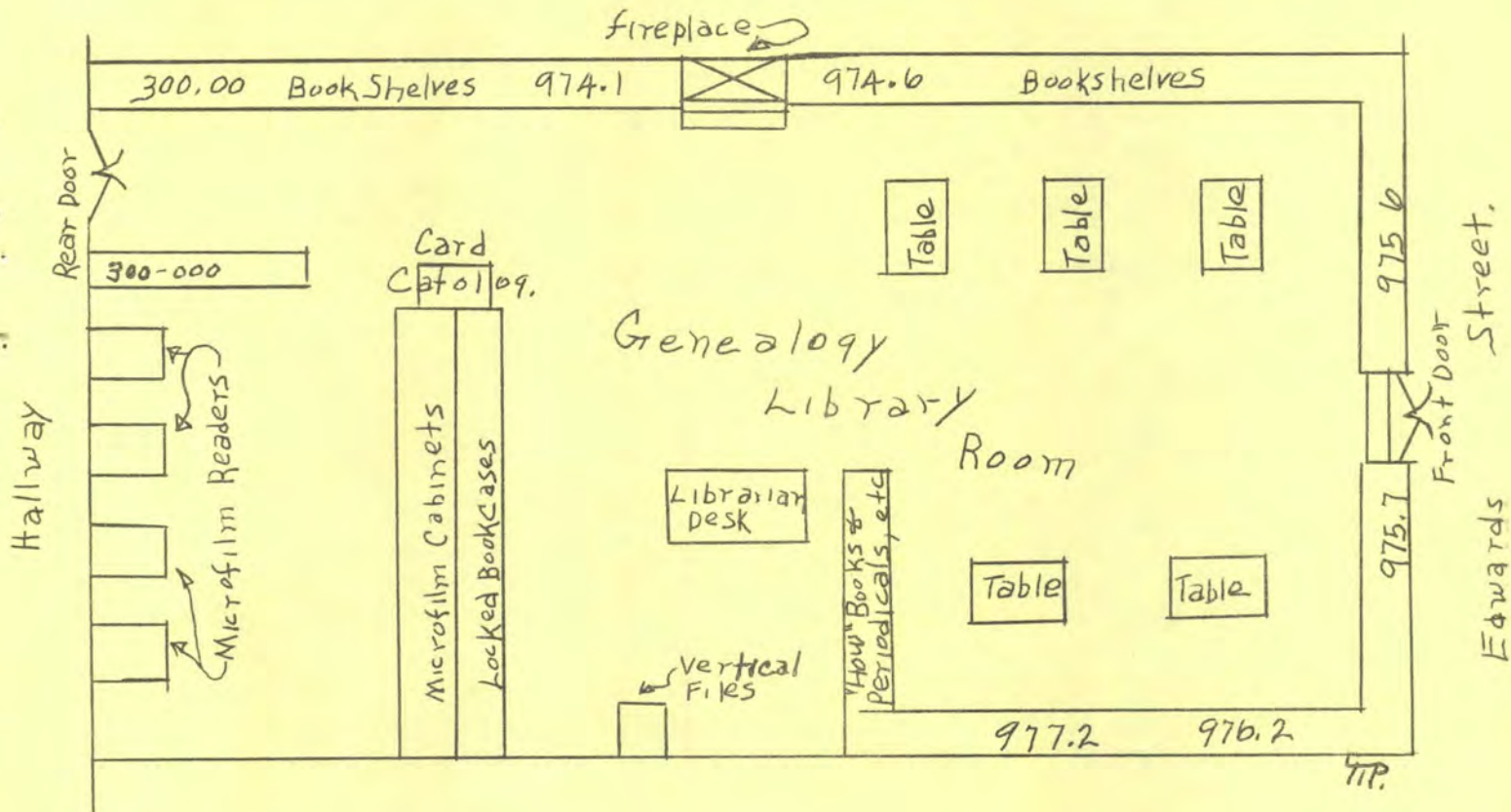

The general reference books start in the island book case in front of the microfilm readers. The numbers follow around the room in order. THE BOOKS IN THE LOCKED CASES ARE NOT IN THE SAME ORDER.

The Card Catalog is set at the end of the locked cases and microfilm cabinets. The Vertical File is behind the librarian's desk.

Periodicals are placed with books of the state they cover. Thus, following the Virginia books, you will find the Virginia Magazine of Biography, the Virginia Genealogists, William and Mary Quarterly. The general periodicals are shelved last, in the island shelf by the librarian's desk. The general periodicals are National Genealogical Quarterly, Genealogical Helper, Southwestern Genealogical Newsletter, etc. Periodicals are not listed in the Card Catalog.

Extremely large books, such as the large Atlas and Louisiana Parish Maps are not kept on the shelves, but on top of the microfilm cabinets, or in other convenient locations where they can be used without moving them.

All except general reference books are grouped by states. Very simply, all the books of Virginia are grouped together, all Georgia books are grouped together. On the preceding page you will find numbers for each state and each category of reference books. Check the numbers with the diagram above and you will be able to find the books you want more easily.

This "Guide to Materials in the Genealogy Room of Shreve Memorial Library" was prepared by Mrs. Margery Wright, Genealogy Librarian, and reprinted by Ark-La-Tex Genealogical Association for the benefit of all who use its facilities.

THE GENEALOGY ROOM NEEDS YOUR HELP

Margery Wright

In 1970, the Genealogy Room of Shreve Memorial Library increased its holdings by 200 new titles. This is an impressive gain, but we fell behind in securing new microfilm. All of you who use this room have felt the need.

The Ark-La-Tex Genealogical Association has given \$200 for new microfilm. This will help, but not cure our problems. Costs for new books and repair of many old irreplaceable books have risen tremendously and the library budget can not begin to cover all that is needed this year, with many needs still left from last year.

The Genealogy Room needs your help. Private donations will be greatly appreciated. If you belong to an organization which is looking for a worthwhile project, you could suggest they consider the Genealogy Room, or that they send memorial books to us instead of wreaths in memory of departed members and friends. Such memorial books are carefully labelled, acknowledged, and fitting notification sent to the family. If you belong to a patriotic organization, suggest they make a special contribution and expand their support of the Genealogy Room and its facilities.

Remember, a gift to the library is tax deductible. We need your help this year.

Do you have any back issues of genealogy periodicals that you no longer need or use? We are in need of many back issues of several periodicals, especially the early issues of Genealogical Helper. Please send us any you do not need. These are tax deductible, too.

Volunteer help is needed in the Genealogy Room for several hours each day to help with sorting, typing, filing, to work on the Vertical Files and for many other details. This is urgent. Please call Margery Wright at 423-2614.

TO ALL MEMBERS AND FRIENDS OF THE ARK-LA-TEX GENEALOGICAL ASSOCIATION:

Now is the time for all good ancestor hunters to come to the aid of the Genealogy Room. You are urged to consider very seriously all needs described by Mrs. Wright. Any need of the Genealogy Room is our need, too, individually and collectively. Let's get together on this at once. If you have any spare time, money, or back issues of periodicals available, turn them in to Mrs. Wright immediately.

Members of the Beginner's Class in Genealogy, sponsored by our Association, would do well to take advantage of this opportunity to learn more about the Genealogy Room by offering your volunteer services for a few hours each week. You will get a liberal education in how to use the library in a hurry and learn more than you could ever hope to in any other way. When this emergency is over, you will know the answers to many questions you may never even think to ask and will be able to carry out your research with much greater efficiency and success.

I am making this a personal appeal to all members, to all who read The Genie, and to all who use the facilities of this library. Margery has never asked for help before. We can not let her down. We can not let ourselves down. The benefits and rewards for meeting these needs promptly are beyond estimation for all of us.

In all sincerity,

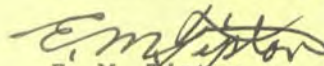

E. M. Tipton
President

Ark-La-Tex Genealogical Association

MOORING FAMILY BIBLE RECORDS

The family data pages of this old Bible belong to Mr. Bickham Christian of Shreveport, who is a descendant of the Mooring family, founders of Mooringsport on Caddo Lake. Mr. Christian has very kindly given permission for The Genie to publish these records. Copied 6 January 1971 by B. R. Randolph.

Marriages

Timothy Mooring and Eliza Ann Bryant was married the 29th of January 1822.

James D. Noel and Mary Ann Mooring was married the 2nd day of January 1844.

Timothy Mooring and L. A. Leveret was married the 14th day of June 1859.

Births

Timothy Mooring, son of Henry Mooring and Margaret his wife, was born the 4th day of March 1801.

Eliza Ann Bryan, daughter of William Bryan, his wife, was born the 24th day of February 1804.

Mary Ann Mooring, their daughter, was born the 11th of November 1822.

William B. Mooring their son was born 2nd day of November 1824.

Margaret Mooring, daughter of Timothy Mooring and Elisa Ann his wife was born 29th of January 1827.

Olive C. Mooring daughter of Timothy and Elisa Mooring was born the 18th of February 1828.

Cullen B. Mooring was born the 14th of May 1829.

Timothy H. Mooring was born the 11th day of September 1830.

Susan E. Mooring was born the 28th day of December 1832.

John Mooring, son of Timothy and Elisa Mooring was born 18th of August 1834.

Henry Lafayette Mooring was born the 4th of August 1836.

Martha E. Mooring daughter of Timothy Mooring and his wife was born July 3rd 1838.

Priar E. Mooring daughter of Timothy Mooring and his wife was born the 5th of June 1840.

Francis F. Mooring daughter of Timothy Mooring and his wife was born August 24th 1842.

Priscilla Mooring was born 27th of October 1844.

Deaths

Susan Elizabeth Mooring departed this life the 8th of February 1844.

John Mooring departed this life the 15th of July AD 1840.

Henry L. Mooring departed this life the 16th of August 1837.

Francis F. Mooring departed this life the 27th of June 1843.

William B. Mooring departed this life the 2nd of January 1851.

James D. Noel departed this life the 17th of December 1849.

Eliza Ann Mooring departed this life the 17th of June 1857.

Mary Ann Noel departed this life 2nd of June 1869.

Mooring Bible Records Cont'd:

Priar Hearne died November 8th, 1876.
Timothy H. Mooring died October 24th, 1878.
Timothy Mooring died September 30th, 1880.
C. B. Mooring died November 9th, 1885.
Martha E. Christian died 29th March 1893.
Margaret A. Croom died July 21st 1897.
Olive C. Hearne died January 29th 1909.

(Also written in the deaths section are the following, probably copied from an older Bible, in the same handwriting as most of the Mooring entries.)

Henry Mooring was born the 16th of January 1767 and departed this life the 6th of January 1806.

Margaret Edmondson was born the 28th of April 1769 and departed this life the 31st October 1836. (Note: Her maiden name was Margaret Cannon, she married (1) Henry Mooring, (2) Cullen Edmondson).

Cullen Edmondson was born July 17th 1775 and died the 24th of June 1836.

Polly Mooring was born the 11th of November 1796 and departed this life the 23rd of October 1820.

William Mooring was born 28th of May 1803 and departed this life 20th of March 1821.

Wyatt Mooring was born the 16th of August 1805.

Eliza Ann Edmundson was born the 29th of August 1814.

Priar Ann Jordan Lane was born the 16th of March 1819.

Pricilla Burcham died June 21st 1916.

James A. Burcham died July 27, 1921.

The following was copied from records in Vertical Files, Genealogy Room, Shreve Memorial Library by Margery Sue Norton. The record was in German except the last entry, that of John Peter Kemper's death, which was in English. The translation was made by Miss Hattie Schuster.

KEMPER FAMILY BIBLE

1738, September 7th, John Peter Kemper was married to Elizabeth Fitzbachin (?). God give us His blessings so that all will go well and bless us with children. That Faith in God will bring blessings and that we will always keep knowing the Love of God and the Holy Truthfulness will always find us ready to live as we should.

1740 on the 13th day of August, 5 o'clock in the morning our son John was born.

1743 on the 25th day of January in the morning at six o'clock was born a son Peter.

1745 on the 31st of Aug. at nine o'clock in the morning was born a daughter Sarah.

1748 on June 20th in the morning at 5 o'clock was born a son Frederick.

1751 the 5th day of January at 7 o'clock in the morning a daughter Judith was born.

Kemper Bible Records - Cont'd

1753 on the 23rd of Nov. in the evening at 7 o'clock Jacob was born.

(Illegible Line)---- Carl --- son was born.

176- on April 19th in the morning at 6 o'clock a daughter Berdi (?) was born.

176- on the 19th day of March at 2 o'clock in the morning a daughter Agnes born.

1768 February 16th at ten o'clock in the evening Elsi was born.

1768 on the 21st of February in the evening Elizabeth passed on. The age she reached was 45 years and 8 days.

1783 November 20th in the morning at one o'clock son Frederich died. The age he reached was 35 years, 8 months and 5 hours.

1788 Sunday evening June 1st when the above named John Peter Kemper, in usual health walking alone in the field departed this life, unknown to any of his distressed family until the next morning. Supposed to have been seized by an apoplectic fit.

The Frontpiece of Family Bible of John Warren Walker

THE

HOLY BIBLE

Containing Old and New Testaments

BOSTON

Published by Langdon Coffin

1831

Family Record

Children of Robert Walker and Elizabeth Eady, Married May 20, 1932
in Amite County, Mississippi

John Warren Walker	born April 1, 1833
Amanda Walker	born June 11, 1835
Robert H. Walker	born April 5, 1838

John Warren Walker and Marthaan Francis Carlton Married
October 19, 1854

Robert H. Walker Mar. Sarah Lambert February 3, 1859

Amanda Walker Mar. Thos. H. Smissen December 18, 1855

Deaths

John Warren Walker	died March 25, 1916
Robert H. Walker	died February 16, 1884
Amanda Smissen	died April 29, 1859

Marthaan Francis Carlton Walker	died March 29, 1901
Robert Walker	died April 30, 1838
Elizabeth Eady Walker Stephens	died July 23, 1897

The above family record and all other family records in this Bible were copied by Ema(Etheredge) Blackmaar 16 January 1923 and certified as correct in 1961 when the Bible was in possession of Mrs. Alma Walker Cranford, Shreveport, Louisiana. A few years later, the Bible was lost in a fire. Let this be a warning: Get Certified and photocopies of all old Bible records available to you at once, lest the old Bible be lost in some way, and keep them in a separate place from the Bible.

MARRIAGES AND OBITUARIES FROM THE NEW ORLEANS CHRISTIAN ADVOCATE

Copied By
Billy Randolph

VOLUME II

No. 1, Feb 1852, Page 3, Col. 1

Married 26 Jan 1852 in Napoleon, Miss. by Rev. E. D. Pitts, Mr. RICHARD W. WILLIAMS to Miss MEDORA C. EAGER, all of this place.

No. 2, 14 Feb 1852 - No deaths or marriages.

No. 3, 21 Feb 1852, Page 3, Col. 1

Married on 5th instant by Rev. H. J. Hunter, Mr. JOHN L. ROBINSON of Wilcox Co., Ala. to Miss MARY E. W. CHRISTIAN, dau. of Rev. Wm. W. & Rohdy C. Christian of Carloville, Dallas, Co., Ala.

Departed this life 20th Jan 1852 at the residence of her brother-in-law, D. F. SANFORD, in the Fork, Greene Co., Ala., in the 25th yr. of her age, Mrs. JANE AMANDA consort of Rev. L. B. McDONALD of the Ala. Conference. She was the third daughter of WM. & NANCY MASSEE and was born in Stafford Co., Va. April 15th 1827. The family settled in Greene Co. in 1835. She married Rev. L. B. McDonald in the fall of 1843. Pickensville, Ala. 12th Feb 1852; Nashville & Richmond C.A. please copy. W. MURRAH

No. 4, 28 Feb 1852, Page 3, Col. 1

Died suddenly in Montgomery, Ala. Dec 1851, Mrs. CATHERINE PARKER, wife of ROBERT PARKER, Esq., in the 53rd yr. of her age. She was born in Tyrone Co., Ireland, went to England. Not only will her husband and daughter, already widowed and afflicted, miss her, - - - etc. - - -. JOSHUA T. HEARD

Died in Hinds Co., Miss., 18 Feb, SARAH MARIA dau of MARTHA S. B. & the late Rev. JOHN W. CHILDS of the Virginia Conference, aged 8 yrs and a few days. Raymond, 20 Feb 1852; Richmond C. A. please copy. J. T. KENNON

No. 5, 6 Mar 1852, Page 3, Col. 2

Bro. McTeire: "By request, I take my pen to chronicle the life of BRO. JOHN N. FARMER, formerly of Union Parish, La., who died in this city on the 2nd instant aged about 32 years. His body sleeps on the Sierra Nevada." Nevada City, Calif. 16 Jan 1852 J. F. BLYTHE

No. 6, 13 Mar 1852, Page 3, Col. 1

Our beloved sister MARY PENNER SANDERS is no more. Her maiden name was COORPENDER She was married to Mr. ROMULUS M. SANDERS on 25 Feb 1851. On 12th Feb she entered saints everlasting rest, aged 21 yrs, 5 mos, 8 dys. She had been a mother 26 days. Clinton, Miss, Feb 1852; Nashville & Louisville C.A. please copy. O. L. NASH

The Rev. GEORGE B. CONE, who died 15 Jan was a native of Conn., lived New York, Rhode Island, taught at Macon Female College, Ga. Lost his wife, taught at Female College, Macon, Miss., and Columbia Female College, Tenn. Came to warmer climate for his health. Eutaw, Ala., 20 Feb 1852 V. L. HOPKINS

No. 7, 20 Mar 1852, Page 3, Col. 2

Died this city 16th instant of consumption, LEE COCKRELL of Cooper Co., Mo. age 24 yrs. (New Orleans) A Friend

No. 8, 27 Mar 1852, Page 3, Col. 1

Married in Tallapoosa Co, Ala. 11 March by Rev. J. S. HUGHES, JEREMIAH EVANS and Miss ELIZABETH LOVELADY.

Married on the morning of the 16th of March by Rev. F. G. FURGUSON,
Rev. JAMES W. SHORES of the Ala. Conf. to Miss LYDIA A. EDWARDS of Autauga Co.
Died in this city (New Orleans) Thursday March 25, WM. D. son of ENOCH & FLORIDA
EVERETT, aged 2 yrs and 2 mos.

Died at Richardson Place in St. Mary Parish on Sunday 29th instant of typhoid
fever following attack of measles, DANIEL D. B. RICHARDSON, Jr., only son of
DANIEL DUBOSE and MARY REBECCA RICHARDSON, aged 1 yr, 6 mos, 22 days.
St. Marys, La. J. W. R.

No. 9, 3 Apr 1852, Page 3, Col. 1

Died in Autaugaville, Ala. 15th ultimate JACOB SToudenMIRE, Jr., in the 18th year
of his age. March 1852.

Died in Chambers Co., Ala., on 17 March, AUGUSTUS ADKINS in his 19th year, young-
est son of WM and SUSAN ADKINS. Texas Papers please copy. A. B. CAMP

No. 10, 10 Apr 1852, Page 3, Col. 1 & 2

Married in the county of Mobile by the Rev. M. D. THOMASON on the 1st instant,
Mr. HENRY C. L. KEITH to Miss SARAH E. LAPORTE.

Died in Bossier Parish, La. MARY JANE, infant child of JULIA A. MUGGAH and Rev.
STEPHEN J. DAVIES of the La. Conf., born 18 Aug 1851, died 11 Feb 1852 of croup.

On Tuesday 16 instant EMILY DOWSING died suddenly, dau of Maj. WM. DOWSING,
Register of Land Office of this place. Born in Georgia 13 Jan 1819.
Columbus, Miss, 31 Mar 1852 G. SHAEFFER

Information wanted: Respecting BERNARD RODDY who emigrated to the U.S. from North
of Ireland in August 1817 in company with Messrs. JOHN KELSO & JOHN MORROW. The
smallest information requested on this subject be mailed to Rev. H. N. McTYLIERE
or Rev. J. C. KENNER of New Orleans. Editors of all religious newspapers are asked
to publish above in behalf of four orphans whose father died in New Orleans of
Asiatic Cholera in 1851 and the support of whose large and just legal rights now
before Chancery in Ireland depends on this information.

No. 11, 17 Apr 1852, Page 3, Col. 1

Married by the Rev. J. B. WALKER 14th April, Rev. C. T. FRENCH of the Mississippi
Conf. to Miss SARAH BREWSTER of Covington, La.

The Rev. RICHARD HOLMES died 8 Jan at 8½ o'clock p.m. aged 82 yrs. Born Brunswick
Co., N.C. in 1770. He was a preacher when he came to Georgia in 1805 and settled
at Monticello, Jasper Co., but the writer does not know date of his license. He
was a member of the Legislature of N.C. for several years, also of the Georgia
Legislature. Cullodenville, Ga. N.C. Christian Adv. please copy. J. DARBY

Died of consumption at residence of his father-in-law, JOHN S. CHILDERS, Pleasant
Hill, La. on 19 March 1852, HENRY B. HUDSON, in 29th year of his age. A native of
S.C. and resident of La for past 12 mos. He left Georgia and went to Cuba for his
health 16 Dec 1851, returned to New Orleans 12 Feb 1852. Came home to die; up Red
River with his coffin on board and all necessary preparations for his interment.
S. C. Advocate please copy. R. L. C.

No. 12, 24 Apr 1852 - only two pages microfilmed, no marriages or obituaries.

No. 13, 1 May 1852, Page 3, Col. 1

Married on 20 Apr by Rev. L. J. SCHOOLER, the Rev. A. J. COLEMAN of the Alabama
Conf. to Miss SARAH ANN TOLAND of Lowndes Co., Miss.

Married at Bay St. Louis, Miss. on Thurs. 29th ult. by Rev. E. D. PITTS,
Mr. WM. COLBY to Miss MARY E. HOYT, youngest dau. of W. S. HOYT, Esq.

Died in Clarke Co., Ala., LORENZO DOW WEBB. Born Edgefield Dist. S.C. 12 Mar 1812.

Mrs. ANGELINA HAWKINS, dau of MIOL & PRICILLA EZELL, died 2 Feb 1852. She was
born 3 Sep 1796 in Virginia. Her parents moved to N.C. in 1798 and she married
Mr. GABRIEL HAWKINS 9 Nov 1814. Mr. & Mrs. Hawkins removed to Ala. in 1817, set-
tled near Suggsville, Clarke Co. and removed to Wilcox Co. Ala. in 1832. Brother
Hawkins died in 1844. (Skull Springs, Wilcox Co. Ala.) H. B. FARISH

DANIEL YOUNGBLOOD, JR., born St. Helena Parish, La. 22 Dec 1822, joined M. E.
Church in 1842, died 25 Feb 1852.

Livingston Parish, La. 1852

JOHN H. DAVIDSON

No. 14, 8 May 1852, Page 3, Col. 1

Died at her father's residence in Tensas Parish, La. Friday 23 ult. LAURA JANE,
eldest dau of Rev. JAMES & CAROLINE BOWMAN. Born East Feliciana Parish, La. 22 Apr
1839. (Alphenian Inst., Tensas Parish, La.) F. A. F. HARPER

No. 15, 15 May 1852, Page 3, Col. 1

Married on 11th instant at residence of Col. DUNCAN, by Rev. J. B. WALKER,
D. M. FOLKES of Miss. to Miss M. DUNCAN.

Died 14 Apr 1852 Mrs. BERTHA FRANCES, wife of Hon. F. D. RICHARDSON. She was born
Wilkinson Co., Miss. 5 Aug 1819.
Parish of St. Mary, La. R. H. READ

Mrs. REBECCA FRANCES RHODES, wife of Mr. T. C. RHODES, and dau of Rev. T. & MARY
DORMAN, died in this city 28 Apr, aged 23 or 24.
Mobile 2 May 1852 J. H.

Died at his residence in Jefferson Co., Miss., 28 Apr 1852 near close of his 62nd
year, JACOB GUICE, M.E. South, Cole's Creek Circuit, Miss. Conf. Joined M.E. Church
in 1834. Mentions son-in-law Rev. GEORGE C. ARMSTRONG.
Fayette, Miss. 7 May 1852 J. G. JONES
Nashville and Louisville Christian Advocate please copy.

No. 16, 22 May 1852, Page 3, Col. 1

Married 28 Apr by Rev. J. D. FISHER, Mr. T. J. TORBERT to Miss REBECCA P. SLEDGE.
All of Marengo Co., Ala.

Married at Carrollton on the 19th instant by Rev. J. B. WALKER,
Mr. GEORGE BLOOMFIELD to Miss HARRIET E. BALDWIN.

Married in Lafayette Parish, La. on Wednesday 12th instant by Rev. H. A. MORSE,
Mr. MICHAEL DURK to Miss OCTAVIA LEE.

Married on 4 May by Rev. M. McWILLIAMS, Rev. J. H. CRUM of Wilcox Co. to Miss
CATHARINE GLENN of Lowndes Co., Ala.

Died in this place Mrs. JULIA M. TARLTON, wife of WM. A. TARLTON, in the 21st
year of her age. (Marshall, East Texas, Harrison Co. May 10) ALEX HINKLE
The T. W. Banner and Louisville Advocate please copy.

In memory of our dear departed sisters in Christian bonds, MARY G. & ZARA G.
MERRITT. The former born Wheeling, Va., 26 Nov 1832, died 17 Nov 1851. The lat-
ter born 4 Jan 1835, died on the 8th instant. Both died of consumption.
Soldiers Springs, March 16. W. A. SMITH

No. 17, 29 May 1852, Page 3, Col. 1

Married on the evening of the 14th of April by Rev. DAVID LAWRENCE, Mr. C. D. _____ (Can't read) of Sumpter Co. Ala. to Miss MARTHA ANN, dau of Maj. M. ABNEY of Bossier Parish. (NOTE: See Bossier Parish Marriages, Book 2, Page 2 - C. D. Ivey m. M. A. Abney, 14 Apr 1852. Published in this issue of The Genie.)

Married 20 May at Plaquemine by Rev. A. E. GOODWYN, SYLVESTER McCLAIN to Miss JOSEPHINE BIGLEY, both of that place.

No. 18, 5 June 1852, Page 3, Col. 1

Died Mrs. CAROLINE S. BOWMAN, wife of Rev. JAMES BOWMAN. She was born 27 apr 1817 and died in Tensas Parish, La. 12 May 1852.

Died at her father's residence in Tensas, La., HONOR C., 3rd dau of Rev. JAMES BOWMAN and CAROLINE S. BOWMAN, on 4th of May 1852, born 28 Nov 1849.

Died, ANNE E. BOWMAN, 2nd dau of same parents on 6th of May 1852. Born 15 Feb 1852.

Died, WM. G. BOWMAN, 2nd son of same parents, on 18 May 1852, bor 15 March 1841.

The mother and half her children died. The disease was sequala to measles with flux. Alphenian Inst., Tensas, May 30. T. H. F. H.

No. 19, 12 Jun 1852 - Not on microfilm.

No. 20, 19 Jun 1852, Page 3, Col. 2

WM. T. WALL entered as a student at Centenary College 11 Feb 1850. He died at his home in Harrisonburg, La., 20 May 1852, in the 19th year of his age.
Centenary College 1852 R. H. RIVERS

MARY E. NIXON, mu daughter, was born 2 Aug 1836 and died 17 May 1852.
Cayuga, Hinds Co., Miss., 7 Jun 1852 THOMAS NIXON
The Nashville & Louisville Advocates please copy.

No. 21, 26 Jun 1852, Page 3, Col. 1

Married 27 May by Rev. CHARLES J. HALBERG, SETH L. TAYLOR of Avoyelles Parish, La. to Miss MARY ELY of Troy, New York.

Died on the 5th instant near Raymond, Hinds Co., Miss., Mrs. ELIZABETH JANE, wife of JOHN L. W. BULLOCK and dau of WM. H. CATCHINGS of Simpson Co., Miss. She was born 6 Mar 1825, married 2 Oct 1845, and leaves her husband and 3 small children.
Raymond, June 17th 1852 J. T. KENNON

Died 12 May, ROSALIE, in the 7th year of her age, dau of JAMES W. & ELIZABETH A. HOPKINS of this city. (doesn't say which city). W. H. A.

Died in Macon Co., Ala., 5th of May, infant son of S.H.D. & ELIZABETH BELL, aged 2 weeks and 2 days. Charleston C.A. Please copy.

No. 22, 3 Jul 1852, Page 3, Col. 1

Died in Perry Co., Ala., 4 Jun 1852, Mrs. MARY TABITHA WELLS, wife of Rev. J. J. WELLS of the Ala. Conf. Married about 2 years, she leaves an infant daughter.
JAS. K. ARMSTRONG

Died in Somerville, Tenn., 23 May 1852, Mrs. LUCY A. TROTTER, wife of GEO. W. TROTTER, Esq. and dau of the late TURNER ABERNATHY of Virginia. She was born in Lunenburg, Va. 25 Oct 1831, joined M.E.Church in Nottoway, Va. Aug 1847, married Mr. Trotter, a merchant in Somerville, 22 July 1851.
Richmond C.A. please copy.

No. 23, 10 Jul 1852, Page 3, Col. 2

Died at Havana, Ala. on 17th instant, Mrs. HETTY ANN SHELDON, consort of CHARLES A. SHELDON of Greensboro, Ala. and day of the late THOMAS B. WALLACE formerly of New Bern, N.C., in the 30th year of her age.

Greensboro 29 June 1852

A. H. POWELL

Died 8 June, Mrs. MARY, consort of Mr. T. H. SCALES and youngest dau of ALEX. and P. YOUNG. She was born in Claiborne, Ala. 24 Aug 1823, married 16 Sep 1845, and leavea a husband, three small chi'dren, and an aged mother.

G. W. T.

No. 24, 17 Jul 1852, Page 3, Col. 1

Married on 5th of July in Parish of Carroll, by Rev. Z. THOMPSON, Dr. SAMUEL BARD to Miss MARTHA BEARD of said Parish.

Died of consumption in Hempstead Co., Ark. on 16 June 1852, JOSIAS ROSSER.

Texas Wesleyan Banner please copy.

L. M. BLAKELY

No. 25, 24 July 1852, Page 3, Col. 2

Married by Rev. J. T. HEARD in Dayton, Ala., on 22 June, Mr. JAMES L. TERRELL to Miss ELIZABETH F. CATLIN, all of Dayton.

Died 11th instant at Valley Green, Holmes Co., Miss., THOMAS H. WADE, aged 21 yrs, 2 mos, 22 days. 14 July 1852

A Friend

Died 16 May at the house of Col. JOHN W. WOMACK, Eutaw, Ala., JULIA MINERVA, infant dau of Rev. J. T. and MARTHA M. HEARD, aged 16 months.

No. 26, 31 Jul 1852, Page 3, Col. 1

Married in the Village of Gretna, Saturday 24 July by Rev. S. LEE, Mr. FRANCIS ADOLPHE ST. AMANT to Miss LUCY ANN, dau of Mr. WM. H. CONSTANTINE. Louisville Papers please copy.

Maj. B. TALLIAFERRO was born in Wilks Co., Georgia 3 Feb 1787 and died in this place 3 Jul 1852, leaving a wife and seven children.

Demopolis, Ala. 20 Jul 1852

THOMAS H. FOSTER

No. 27, 7 Aug 1852, Page 3, Col. 1

Married in this city on 31 July by Rev. JAMES D. PARKER, Mr. EBZEARD E. BRADY and Miss OREL ARMSTRONG.

Died of consumption 30 July JOHN BALL, a publisher.

A Friend

SARAH JANE CARMICHAEL, dau of Rev. NOAH & SARAH LANEY and consort of Rev. DUGALD CARMICHAEL of the Ala. Conf., was born in Marlborough Dist., S.C. 7 June 1830 and died of typhoid fever at the residence of JOHN W. JACKSON near Clayton, Ala. on 16 July 1852. Leaves a husband and infant son aged 1 year and 8 months.

Ala. Conference 1852

J. L. SANDERS

F. R. SINGLETON was born in Wilkinson Co., Miss. died at 27 years of age. Left and orphan early in life he was raised by an uncle. He moved to Texas where he and his wife joined the M. E. Church.

Jeanerette, St. Mary Parish, La.

J. W. R.

No. 28, 14 Aug 1852, Page 3, Col. 1

Married in Lafayette, Ala. 3 Aug by Rev. E. G. RICHARDS, J. A. FRAZER, Esq. to Mrs. T. H. KEY of Meriweather Co., Georgia.

Married 5 Aug 1852 by Rev. W. VAUGHAN, Mr. JOHN E. MASON of Bibb Co. to Miss LUCRETIA A. GAYLE of Perry Co., all of Alabama.

Died in Philadelphia JOHN BALL in the 29th year of his age, a native of Philadelphia. He came south for his health, had consumption. L. PARKER

No. 29, 21 Aug 1852, Page 3, Col. 1

Married in M. E. Church at Vicksburg 6 July by Rev. JOHN LANE, W. P. BAR-----? of the Miss. Conf. to Miss ---- H. LUNDIE of Vicksburg. (Partially illegible)

Died 13 May in Demopolis, Ala., Mrs. SARAH THOMAS SHIELDS, wife of Hon. --?--- SHIELDS, in the 38th year of her age. Returned from South America with husband and son. J. C. KEENER

No. 30, 28 Aug 1852, Page 1, Col. 3

Died on 29th ultimate at his residence in Caddo Parish, La., aged 39 yrs & 6 mos, Mr. JESSE V. BRANTLY, a native of South Carolina, had resided in Caddo Parish for 12 or 14 years. R. L. C.

No. 30, P. 3, Col. 1:

Died 17 August in Lafourche Interior, La., Mrs. ELLEN R. ARMITAGE in the 28th yr of her age. Joined M.E.Church 1851 at Felicity St. Church in New Orleans. Held her membership at Thibodeaux at her death. Leaves her mother, husband and three small children. Her Pastor

Died 12 July at Millville, Marion Co., Ala., Mrs. SARAH DAVIDSON, wife of JAMES DAVIDSON, Esq., in 56th year of her age. She was born in York Dist., S.C. and reared in a sect of Presbyterians called Seceders. Joined M.E.Church in 1842. GEO. W. TUCKER

Died 2 Aug 1852 in Greene Co., Ala., Mrs. SALINA ANN FERRELL, consort of WILLIAM FERRELL, in the 29th year of her age. Leaves her husband and three small children. August 14 Her Pastor

No. 31, 4 Sep 1852, Page 3, Col. 3

Died at Mississippi City 27th ultimate ONEY S. DAMERON in 63rd yr of his age. A native of Norfolk, Va., member of M. E. Church over 40 years. M.

My father, NAHHULLOBBI LEWIS, died Tuesday 6th of last July. On Friday 30th of same month my only daughter NANCY ALEXANDER aged 3 yrs, 12 dys, died. Doaksville, C. N. Aug 10 D. W. LEWIS

Died in Sabine Co., Texas 13 July in the 51st year of her age, LUCRETIA HICKMAN, wife of ASA HICKMAN. She was born in Missouri, came to North La. in an early day where she married and then some years later moved to Texas. Jasper, Texas August 22. A Friend

Died in Clarke Co., Ala. 13 August JOHN J. PEEPLES, aged about 36 years. Leaves a wife and numerous relatives. J. S. W.

No. 32, 11 Sep 1852, Page 3, Col. 1

Married by Rev. C. C. CALLAWAY on Wednesday morning August 26, GEORGE ---?----- to Mrs. EMILY W. HEARD, all of -----field, Ala. (Partially illegible.)

No. 33, 18 Sep 1852, Page 3, Col. 1

Died in Benton, Miss. 16 Jul 1852, WILLIAM M. SMITH born in Cumberland Co., Va. 27 Oct 1814. An affectionate husband and kind father, etc. L. P.

SAMUEL HAWES buried his wife RACHEL Yesterday. She died at her mother's on the 7th, a new born infant at her side. Baton Rouge, September 9 W. H. CRENSHAW

No. 34, 25 Sep 1852, Page 3 Col. 1

Died in Centreville, Bibb Co. Ala on 10th instant, J. C. CAMPBELL, in 38th yr of his age. Leaves a wife and five little children. Centreville, 13 Sep 1852.
Also resolutions of Friendship Lodge No. 83. J. C. STRICKLIN

No. 35, 2 Oct 1852, Page 3, Col. 1

Sister L. M. HAMILL dau of ROBERT & KEZIAH WILLIAMSON and consort of Rev. R. G. HAMMILL, was born in Greene Co. Ala. in 1819, made profession of religion in 1846 and died in Greensborough 29 Aug 1852. An honorable stepmother, etc.
Demopolis, September 1852 THOMAS H. FOSTER

Died at his summer residence near Bladen Springs 2 July last, WM. ECKFORD, Esq., late of Mobile, Ala. Born in Petersburg, Va. 7 Oct 1802, and emigrated to this state in the early settlement of the country. Columbus, Miss. 20 Sep 1852 D.

Died 11 August, WILLIAM LEWIS, son of L. & A. McCARTY, aged 2 yrs & 7 months.
Demopolis, Sept 1852 THOMAS H. FOSTER

No. 36, 9 Oct 1852, Page 3, Col. 1

Miss ISABELLA ELDER died in Greensboro, Ala. on 1st of October. Joined the M. E. Church in Mobile. J. T. KOGER

Died 2 Sep 1852 at his residence near Pickensville, Ala., Major EVERARD CURETON in 71st year of his age. A native of Virginia, from early life lived in S.C. Moved to Alabama in the Fall of 1834.

No. 37, 16 Oct 1852, Page 3, Col. 1

Married on 5 August by Rev. - W. ELLIS, L. H. ROBISON, Esq. of Wilcox Co. Ala. to Miss FRANCES W. CHRISTIAN of Dallas Co. Ala.

Married in the Village of Gretna on Monday 11th instant by Rev. S. LEE, Mr. ROBERT YOUNG and Miss ANN WAUGH.

Died at 4 O'clock this morning at residence of her father on Bayou Black, Terra-bonne, La., LOUISA, 2nd dau of MICHAEL KNIGHT, Esq., aged 12 yrs, 6 mos.
Tigerville, La. 6 October 1852 M. H. H.

No. 38, 23 Oct 1852, Page 3, Col. 1

Miss EVELYN VAUGHAN was born in Madison Co., Tenn. 12 March 1831 and died at her father's residence in Marengo Co. Ala 14 Sep 1852.
Summerfield, 8 Oct 1852 A. H. MITCHELL

No. 39, 30 Oct 1852, Page 3, Col. 1

Married on Saturday evening the 19th instant in Algiers by Rev. JAMES D. PARKER, Mr. ISAAC ALLEN to Miss EMMA KING.

JAMES F. McBRIDE died in Mobile 6 Oct after a lingering illness. He was born in Pennsylvania 9 March 1800 and came to Mobile in 1826.
19 Oct 1852. Southern C. A. please copy. D.

No. 40, 6 Nov 1852, Page 3, Col. 2

Married 13 October at 6 O'clock p.m. by Rev. C. D. OLIVER, JAMES A. HARVEY of Auburn, Ala. to Miss SUSAN J. OLIVER of Montgomery.

Married on 14th ultmate by Rev. Dr. MANLY, GEORGE W. BENAGH, Professor of Mathematics at the Universtiy of Alabama, to Miss MARY W. COLLIER, eldest daughter of HIS EXCELLENCY GOVERNOR COLLIER, all of Tuscaloosa, Ala.

Died in Caddo Parish, La., Nancy Jane, age 2 yrs, 8 mos., dau of BENJAMIN & ADELINE WHITWORTH. Mansfield, October 1852 JANE.

Died 12th instant in his 22nd year, ALFRED D. KING, son of Col. A. P. & CATHARINE LUCAS KING, for the last two years he has resided in Bienville Parish, La. where he joined M. E. Church. Drowned while trying to swim his horse over a swollen Stream. B. W. P.

No. 41, 13 Nov 1852, Page 3, Col. 1

Married on morning of 3rd instant at residence of Mr. JOHN MIXON by Rev. C. C. CALLAWAY, WM. E. IVY and Miss FRANCES MIXON, all of Dallas Co. Ala.

JAMES WILLS died 2 Nov 1852 in Green Co. Ala. in his 30th year, last born and 1st to die of 10 children. Suffered for the last six years. J. WESLEY LANEY

ALEXANDER TALLEY MIMS, M.D. died -- Oct in his 29th year at Cooper Wells, Miss. His home in LaGrange, Ala. Educated for medicine at Philadelphia, lived at Summerfield, Ala. Dr. J. T. KENNON sent a letter to his father-in-law Col. R. A. BAKER, relating the circumstances of his death.(Summerfield,Ala.)C. C. CALLAWAY

No. 42, 20 Nov 1852, Page 3, Col. 1

Married on 10th instant by Rev. A. J. COLEMAN, Rev. L. B. McDONALD of Ala. Conf. to Mrs. MARY A. BRASHER of Shelby Co., Ala.

Married on 2nd instant by Rev. DANIEL DUNCAN, JUDGE W. REMBERT of the "Hills" to Miss FANNIE TERRELL of Dayton, all of Marengo Co., Ala.

Married on 2 Nov 1852 by Rev. P. M. GOODWYN, Dr. J. H. FILES and Miss MATILDA MARTIN, all of the Parish of Ouachita, La.

Died on 2nd instant at residence of her brother-in-law, Mr. IRA BOWMAN of Tensas Parish, Mrs. MARGARET S. BOWMAN, wife of ROBERT BOWMAN, Esq. and youngest daughter of Col. JOHN G. RICHARDSON of St. Mary's Parish, in the 26th year of her age of consumption. Centerville, Amite Co., Miss. 16 Nov 1852 J. WINANS

Died 21 Sep 1852 in Green Co., Ala., Miss SARAH K. MASSEY, age 27. B.S.WILLIAMS

Died 4 Oct 1852 JOHN LITTLE, son of ARMSTEAD & CAROLINE OTEY, 3 yrs, 7 mos, 23 dys.

No. 43, 27 Nov 1852, Page 3, Col. 2

Married 11 Nov near Gaston, Sumpter Co. Ala. by Rev. ALEX McBRYDE, Mr. JAMES F. CARR, formerly of N.C. and Miss ANN JANE LARKINS, eldest dau of JOHN M. LARKINS, dec'd.

Dr. JOHN S. HESTER, formerly of Alabama but lately of Caldwell Parish, La. died of Consumption 6 October last. Mt. Pleasant, La. Nov 13 THOMAS MEREDITH
Eutaw, Ala. papers requested to copy.

No. 44, 4 Dec 1852, Page 3, Col. 1

Married by Rev. F. G. FERGUSON on Sunday morning 21 Nov, Rev. L. M. WILSON of the Ala. Conf. to Miss MARY H., dau of EDWARD DUDLEY, Esq. of Lowndes Co., Ala.

Married 18 Nov by Rev. J. PIPES, Mr. EDMOND CAVALIEER to Miss VIRGINIA P. MORRIS.

Died on 9th instant at residence of her father, JOHN S. CHILDERS, Pleasant Hill, DeSoto Parish, La., Mrs. SARAH E. HUDSON in 28th year of her age. She lived to see all her children but one die. 16 Nov 1852. Southern Advocate please copy.

Died near Pine Knot, Macon Co., Ala., HESSALINA TURNER, wife of Rev. W. E. TURNER and dau of the late JOSIAH & SYLVIA BRUNSON of Lincoln Co., Ga., where she was born 9 Oct 1827. Removed with her brother to near Auburn in 1844. W. P. MILLER

Died 18 Nov at residence of her father-in-law, Maj. HENRY TURNEY, AMANDA F. HARPER consort of A. G. TURNEY and 2nd dau of W. W. & M. T. HARPER, in 22nd yr of her age. Mount Rose, Caddo Parish, La. W. P. WINANS

No. 45, 11 Dec 1852 - Only 2 pages microfilmed, no obituaries or marriages.

No. 46, 18 Dec 1852 - None

CHRISTIAN ADVOCATE, VOL II, Cont'd. No. 47, 25 Dec 1852 - No Obituaries or Marriages
No. 48, 1 Jan 1853, Page 3, Cols. 2 & 3

Married by Rev. W. J. FERGUSON on 21 Dec 1852, Mr. M. C. CALLIHAN to Miss IRENE A. WALLIS, all of Parish of Terrabonne, La.

Died 16 Dec 1852, SARAH ELIZABETH DAMERON, wife of W. H. DAMERON of this city, in the 27th year of her age, native of Princess Anne Co., Va. K.

Died in Carrollton 30 Oct 1852, ELIZABETH FULTON, wife of JESSE FULTON, in 58th yr. of her age. A consistent Christian both in this state and in Ga. J. C. KEENER

Died in Clark Co. Ala 7 Nov 1852 Mrs. NANCY ANN LANCASTER, wife of A. LANCASTER and day of MILTON & MICHAL FORD. A member of Baptist Church in Marengo City, Ala. Leaves husband and children. JOHN W. ALEXANDER

No. 49, 8 Jan 1853, Page 3, Col. 1

Rev. JOHN H. HINES died at Farmerville, La. 23 Oct 1852, born 6 Aug 1788 Albemarle Co. Va., joined M.E.Church 1820 or 21. In 1833 received a charge from Rev. R. WEST in Yalobusha Co., Miss. Nashville & S.C. C.A.'s please copy. W.B.H.

Died in Shreveport, La. 17 Oct 1852 JAMES K. BAYLISS in 40th yr of his age. Native of Virginia, resided for some time in North La. where he married Miss FRANCES BAYLISS, then moved to Caddo Parish, a merchant. Greenwood,La. C. G. YOUNG

Died 23 Dec 1852 at residence of her mother in Plaquemines, La., Mrs. JOSEPHINE, wife of SYLVESTER McCLAIN; born in Plaquemines 11 Jul 1836, married 20th of last May and joined M. E. Church on August 1. A. E. GOODWYN

Died in Jackson, Clarke Co. Ala. 4 Nov 1852, Mrs. BARBARA CHAPMAN. Converted to M.E.Church in 1825, she leaves a husband and 2 children. A. D. DICKINSON

No. 50, 15 Jan 1853, Page 3, Col. 1

Sister RACHEL SAFFEN, born in New Brunswick, N.J., died at Pensacola Navy Yard 19 Nov 1852 in 39th yr of her age, consumption. Leaves husband and three children. T. C. STANLEY

No. 51, 22 Jan 1853, Page 3, Col. 1

Married in Marshall, Texas by Rev. J. S. TULLIS 23 Dec 1852, W. T. CURLIN to Miss MEXICO A. CURLIN, both of Marshall. Married in Methodist Church.

Married in Marshall, Texas by Rev. J. S. TULLIS 23 Dec 1852, W. W. ADAMS to Miss MARY J. JOHNSON.

Married by Rev. I. M. WILSON on 11 January, EDWARD DUDLEY, JR. to Miss PARMELIA A. BILBERRY, all of Dallas Co., Ala.

Died in Marion, Ala. 4 Dec 1852, JOHN HARVILLE, son of Rev. JAMES K. & L. S. ARMSTRONG, aged 2 yrs and 4 mos.

Mrs. SARAH ANN GREEN, wife of THOMAS F. GREEN and dau of EDWARD SToudenMIRE, was born 2 Sep 1830 and died 29 Nov 1852 in her 22nd year. Summerfield, 7 Jan 1853 A. H. MITCHELL

No. 52, 29 Jan 1853, Page 3, Col. 2

Died at residence of his brother-in-law, Dr. SAMUEL B. MALONE, Columbus, Miss., on 13 Dec 1852, JOHN JAMES SYKES of the firm of J. J. SYKES & CO. of Mobile, Ala. He was born in Decatur, North Alabama and died of consumption. Columbus, Miss. 17 Jan 1853. THOMAS W. DORMAN

***** END VOLUME II OF THE NEW ORLEANS CHRISTIAN ADVOCATE *****

Where place is designated as "this city", New Orleans is implied, since that is where the Christian Advocate was published. The 19th Instant means 19th of month reported or published; 19th Ultimate means 19th of previous month.

BOSSIER PARISH MARRIAGE RECORDS, BOOK 2, 1850 - 1867

Copied by Mrs. Sam J. Nation & Mrs. James T. Evans

For Book 1, Bossier Parish, La., Marriage Records, 1843-1851, also copied by Mrs. Nation & Mrs. Evans, see THE GENIE, VOL I, January 1971, No. 1, pp 13 & 14.

GROOM	BRIDE	DATE	PAGE
Allen, Cancellion C.	Jane Cook	20 Oct 1850	17
Arnett, G. W.	Mary R. Cavett	1 Jan 1852	34
Applewhite, Jesse	Mary Knox	23 Dec 1851	37
Alexander, G. B.	Mary D. C. Cane	4 Jul 1850	48
Allen, James	Virginia A. E. Harris	9 Feb 1854	138
Applewhite, John L.	Julia A. Lawrence	26 Aug 1852	140
Allen, John G.	Emily S. Spurlin	21 Dec 1854	174
Anglin, Wm. O.	Mrs. Mary Jane Herring	14 Mar 1855	181
Allen, H. H.	Elizabeth Ann Shaver	16 Oct 1855	205
Allen, Wm.	Sarah Moore	24 Oct 1855	207
Abney, Francis	Sarah Marks	18 Dec 1856	242
Anderson, C. A.	Martha J. Lightsecy	5 Feb 1857	253
Adams, Davis	Elizabeth Deloach	7 Apr 1857	262
Alford, A. M.	Lu E. Born (Boon ?)	20 Aug 1861	374
Allen, Rufus H.	N. M. Liverman	2 Apr 1861	378
Andrews, James	Nancy Catherine Lay	7 Jan 1862	394
Adams, Joseph W. P	Elpha Wallace	20 Jan 1861	436
Abney, Thomas W.	Mary E. Slack	28 Dec 1860	486
Austin, S. F.	Mrs. Mary Crownover	20 Sep 1866	540
Allen, Willis	Sarah S. Powell	5 Apr 1866	543
Barker, James	Amanda Evans	13 Nov 1851	36
Bundy, A. J.	Louisa E. Ford (License date)	18 May 1852	65
Bryan, J. D.	Caroline C. Johnson	2 Mar 1853	88
Bryan, Joseph N.	Harriet Hamiter	20 Jul 1853	112
Bell, James J.	Mary Jane Sanders	9 Nov 1854	134
Bush, Moses E.	Mary Willard	23 Feb 1854	147
Busby, Jesse J.	Elizabeth M. Gee	23 Nov 1854	167
Butts, Charles	Nancy Dennard	1 Feb 1855	177
Bryan, James R. (Lic. 24 Mar)	Elizabeth Jane Farmer (Return)	4 Apr 1855	184
Burton, Wm. B.	Mrs. Nancy McDade	29 May 1855	190
Busby, Wislon W.	Mrs. Martha Burnham	12 Feb 1856	211
Barnacastle, Henry	Patience P. Lisler	23 Apr 1856	225
Boswell, Davis O.	Cornelia Nattin	3 Jul 1856	235
Butler, Chas. Q.	Nancy C. Ray	13 Jan 1857	249
Boles, Wm. H	Maria Warson	19 Arp 1857	263
Barnett, Albert	Nancy P. Cochran	15 Aug 1858	322
Boggs, Samuel J.	Mary A. Barnett	22 Sep 1858	328
Beaird, Wm. J.	Mary A. May	29 Dec 1858	341
Bush, W. C.	Mrs. P. C. May	15 Oct 1862	352
Boggs, Samuel A.	Louisa Davis	7 Jun 1863	359
Bickley, Samuel	Mrs. Nancy Nattin	20 Aug 1861	385
Brian, Daniel F.	Josephine Presnal	23 Oct 1860	419
Butler, J. S.	Lucinda Sapp	8 Nov 1860	421
Byrd, James L.	Sarah E. Lewis	25 Dec 1859	476
Bush, W. C.	Mrs. Martha A. Montgomery	26 Sep 1866	534
Coleman, Hugh G.	Ellender Delafield	25 Dec 1850	26
Cavett, J. B.	Sarah Jane Martin	30 Oct 1850	50
Clinton, David	Mrs. Salina Mobley	23 May 1852	55
Cross, Henri C.	Manerva L Inabnet	1 Jun 1852	60
Covington, Wilson	Helen Montgomery	10 Aug 1852	70
Carr, Thomas	Elizabeth A. Braden	17 Nov 1852	79
Cargill, Samuel E.	Letha W. Sims	31 Dec 1852	82

BOSSIER PARISH, LA. MARRIAGE RECORDS, BOOK 2, 1850-1867, Cont'd

Chaffe, Charles	Eliza Amelia Skannal	11 May 1853	100
Clark, Edmund S.	Sarah Mitchell	2 Aug 1853	107
Covington, William	Clarinda Shaver	12 May 1853	110
Curry, Jesse B.	Tabitha G. Martin	30 June 1853	113
Cook, Francis M.	Elizabeth Hart	10 Aug 1853	119
Cockrell, Jerimah	Julia A. Hughes	21 Dec 1853	125
Cockrell, John, Jr.	Ann C. Tipton	22 Dec 1853	127
Connell, Elias F.	Elizabeth A. Jones	2 Feb 1854	136
Crownover, John	Mary Ann O'Neal	8 Dec 1853	144
Copes, Wm. Curtis	Mary Ann O'Neal	14 Feb 1854	144
Cummings, Robert C.	Sallie A. Pickett	19 Dec 1854	171
Crownover, Benj. F.	Amanda O'Neal	4 Feb 1855	179
Collins, W. C.	P. Ann Hilton	17 Apr 1855	185
Carstarphen, Joseph J.	E. Virginia Lowery	23 Jan 1856	209
Coyle, Hugh B.	Mary C. Dick	13 Jul 1856	236
Chisolm, John L.	Mildred E. Rodgers	18 Dec 1856	241
Crabtree, Wm. K.	M. R. Byrd	25 Dec 1856	245
Coyle, Clark G.	George Ann Anderson	27 Jan 1857	250
Cole, George	Mary Ann Statton	9 Feb 1857	256
Curry, Augustus A.	Lucinda E. Engram	19 Mar 1857	260
Cook, Nathaniel A.	Martha High	4 May 1857	263
Clark, Edward S.	Elizabeth A. Mosely	21 Oct 1857	271
Cason, E. A.	Sintha Harris	12 Nov 1857	273
Cason, James	Adelea Harris	28 Aug 1856	277
Cahill, John P.	Mahala F. McClanahan	25 Feb 1858	300
Cason, Elijah M.	Mrs. Virginia Allen	4 Feb 1858	302
Covington, Robert	Lizzie E. Liverman	17 Jun 1858	315
Curry, Jess G.	Mary Jane Taite	5 Aug 1858	323
Cochran, Edmond B.	Mrs. T.J. Wheeler (nee Madden) filed	28 Oct 1858	320
Caplas, John	Ann Murphy	16 Dec 1858	342
Carloss, W. W.	Emma Stewart	4 Mar 1863	357
Cagle, Elijah	Charlotte C. Heath	9 Jun 1861	383
Cavett, J. B.	Mrs. M. R. King	9 Feb 1862	382
Cavett, D. Franklin	Ann Elizabeth Owen	1 Mar 1860	403
Chilolm, George W.	Sarah A. Lee	29 Dec 1859	474
Cavett, James R.	Martha Doles	1 Jan 1861	484
Calloway, Abraham	Lucinda Price	12 Jan 1867	492
Cross, Henry	Eliza Walton	23 Jun 1866	502-3
Childers, A. B.	Sophia Hall	24 Apr 1866	523
Curry, R. H.	Mrs. M. A. Bell	20 Dec 1865	527
Chapman, A. C.	V. E. Sanderson	22 Jul 1866	529
Cade, John W.	Martha Lowery	12 Jul 1865	557
Carpenter, William C.	Manah Wiley	1 Oct 1865	558
Cavett, R. S.	Virginia J. Martin	26 (?) May 1853	551
Crownover, Wm.	Mary A. E. Sandefor	15 May 1859	456
Durham, Joel	Sarah J. Rounsavall	26 Oct 1852	74
Durham, B.B.	M. A. R. Rounsavall	30 Feb 1853	96
Doyle, John Marion	I. R. L. C. Carter	9 Nov 1853	123
Dudley, Juliam J.	Victoria L. Ford	4 Jan 1854	130
Dalrymple, John W.	Patience Winham	20 Dec 1854	175
Dickson, David F.	Caroline N. Graham	1 May 1855	187
Dennard, Daniel Jasper	Amanda J. Smith	3 May 1855	188
Durst, Jacob A.	Elizabeth B. High	22 Aug 1855	199
Davis, John	Luisa Haine	30 Sep 1855	201
Doyle, Pleasant R.	Celia Jane Snider	23 Jul 1856	233
Dorch, Wm. E.	Mary A. Doyle	23 Jul 1856	231
Dixon, James M.	L. Dalrymple	28 Oct 1856	240

BOSSIER PARISH, LA. MARRIAGE RECORDS, BOOK 2, 1850-1867, Cont'd

DeSoto, Joseph	Louisa Porier	25 Dec 1856	245
Dudley, Arthur	Elizabeth J. (?)	5 Aug 1858	321
Doyal, Simon W.	Permelia T. Rabourn	30 Sep 1863	341
Davies, Gabriel S.	Sarah Fannie Herron	14 Aug 1860	415
Dorch, James N.	Ann E. Swearingen	2 Nov 1859	467
Dunn, James M.	Louisa Jane Stricklan	16 Jun 1859	456
Doyal, John M.	Margaret L. Raborn	7 Feb 1859	447
Deck, Miles F.	Victoria A. Glover	16 Jul 1856	552
Daniel, Henry H.	Sallie R. Smith	15 Jan 1867	516
Doudle, Allen	Mrs. Josephine Floris	25 Dec 1866	518
Dovle, J. Marion	Georgia Ann Applewhite	31 Jan 1866	519
Edwards, W. J.	K. Hollingsworth	30 Mar 1852	62
Edwards, Benjamin S.	Emma C. Browning	15 Jul 1855	195
Edwards, Isaac D.	Emma A. Lawrence	25 Dec 1855	217
Edwards, Erasmus	Martha Edwards	20 Dec 1857	285
Eams, Nathaniel Webb	Mary A. McIntyre	19 May 1858	301
Edwards, J. J.	Mary A. Hicks	22 Dec 1858	338
Edwards, Patrick H.	Julia A. Persnal	15 Jan 1861	404
Egan, Wm. B.	Mary A. E. Hodges	3 May 1860	407
Engram, James	Suzan Mayfield	12 Oct 1859	410
Engram, James	Martha A. Rodgers	4 Dec 1860	425
Edins, James	Telitha Thomas	27 Jan 1859	444
Edwards, Henry W.	Elizabeth A. McClanahan	29 Dec 1866	513
Faircloth, Lemuel	Mrs. Amar Prevost	10 Apr 1851	11
Ford, A. T.	Martha M. McGary	21 Jun 1851	23
Fuller, James	Fanny Bodenhummer	8 Feb 1854	137
Forehand, F. D.	Mrs. Mary F. Ferrill	2 Feb 185- (?)	180
Felps, James O.	Miss Mary Ann E. Yarbough	13 Dec 1855	213
Fuller, Thomas W.	Margret A. Wafer	12 Mar 1856	222
Fort, T. M.	Martha A. Connell	24 Jul 1856	234
Ferrington, John	Mary A. Cason	7 Jan 1858	294
Fisher, L. H..	Mrs. S. L. Dobbs	16 Dec 1863	345
Frazier, John	Mrs. Matilda E. Robinson	25 Jun 1861	388
Floyd, Joseph J.	Mary Jane Lockly	11 Aug 1859	455
Felps, John R.	Sarah Campbell	16 Dec 1866	511-12
Graham, Joseph W.	Mary L. Elder	10 Sep 1850	46
Gammon, Richard A.	Louise Land	3 Sep 1852	68
Grounds, Joshua	Miss M. M. McIntire	27 Jul 1854	172
Gentry, James I.	Mrs. Mary Ann Barzeale	21 Jun 1855	193
Green, C. S.	Miss P. J. Malone	11 Oct 1855	204
Garrett, Thos. J.	Mary Ann Dunn	24 Jan 1856	212
Gorden, Bennett	Oregon Tredwell	15 Apr 1856	224
Gibson, John	Rachal G. Taylor	5 Feb 1857	251
Griggs, John J.	Louisa M. Reagon	17 Feb 1857	253
Graves, Rufus Y.	Eliza L. Gilmer	29 Apr 1858	309
Guther, Henry	Jane Hurn	27 Dec 1863	348
Gilmer, George	Rebecca L. Smith	14 Aug 1861	373
Gunn, Wm. M.	Carry S. Smith	25 Apr 1861	375
George, Alexander B.	Penelope P. Hodges	18 Jan 1860	397
Griggs, J. B.	Mary E. Dickson	16 Apr 1861	384
Hadley, John G.	Mary E. Martin	24 Dec 1856	244
Hancock, W. J.	Mary L. Graham	17 Feb 1857	259
Hudson, James D.	Abigail Twiner	2 April 1857	261
Hill, Wm. H.	Ann E. Lockley	20 Oct 1857	270
Henderson, Daniel J.	Mary Jane Toms	17 Dec 1857	284
Holt, Wm.	Levicy Hortman	29 Dec 1857	291
Hurn, James J.	Lizzie P. Dickson	30 Nov 1863	349

BOSSIER PARISH, LA. MARRIAGE RECORDS, BOOK 2, 1850-1867, Cont'd

Hester, W. D.	Laura L. Owen	2 Dec 1862	355
Harper, A. G.	Giraldine Nuckolls	18 Nov 1862	356
Holt, Wm. S.	Jane A. Rodgers	22 Dec 1861	362
High, Wm.	Angeline Willard	18 Aug 1863	366
Hickman, C. A.	Mollie A. Darby	24 Dec 1861	370
Hodges, M. L..	Ann Dick	20 Jul 1862	391
Hodges, John Little	Jenett V. Hamilton	2 Jan 1860	399
Hicks, John M.	Jane Leggett	4 Mar 1860	405
Harper, Ephram	Malinda Carter	12 Jul 1860	411
Hanna, Archibald	Sarah J. Walling	24 Dec 1860	427
Hunter, Dr. J. T.	Octavia C. Hodges	1 Jan 1861	433
Herring, Benj. F.	Eleanor A. McCullen	13 May 1852	52
Hutchinson, Robt. C.	Margaret A. Walker	4 Aug 1852	74
Hudson, Elijah	Sarah Doyle	3 Feb 1853	85
Hamilton, Wm. E.	Virginia Johnson	22 Dec 1853	132
Hodges, Richard	Elizabeth Goodson	26 Aug 1852	142
Higgs, S. R.	Mary E. Felps	2 Mar 1854	150
Hancock, Nath'l	Amanda Lister	20 Apr 1854	154
Hancock, J. C.	Sophia E. Knoblet	24 May 1854	158
Hogge, Elnathan D.	Elvira L. Brian	15 Jun 1854	159
Herd, Allen J.	Martha J. Busby	16 Nov 1854	164
Hickman, Wm. James	Mrs. Mary J. Barnett	19 Dec 1854	170
Heath, Thomas	Elizabeth Young	22 May 1855	189
Heard, Thomas C.	Mary C. Busby	21 Jun 1855	192
Harrison, John	Mahala C. Herring	3 Jul 1855	194
Harrold, W. C.	Amanda Lowerv	27 Jun 1855	198
Heath, John L.	Charlotte Ann Bonds	15 Dec 1855	202
Hamilton, Lander	Mary A. Wallace	19 Jun 1856	228
Herring, Benj. F.	Eleanora A. McCullin	13 May 1852	229
Hodges, J. L., Jr.	Elizabeth V. Burton	8 Dec 1859	471
Hortman, J. J.	George Ann Deck	6 Feb 1859	442
Haley, Wm C.	Mrs. Elmenea Strickland	30 Oct 1859	466
Hughes, Wm. J.	M. A. Clark	26 Sep 1866	505
Hamilton, Jack E.	Matilda Skannal	12 Apr 506	506
Hargis, Wm. C.	Sallie A. Lowe	25 Apr 1866	507
Hawkins, T. G.	Nancy J. Coward	17 May 1866	509
Hamitt, James S.	Sarah F. Boon	12 Jul 1866	547
Ivey, C. D.	M. A. Abney	14 Apr 1852	2
Inabinett, J. A.	Georgia M. Reemer	27 Sep 1859	461
Jenkins, John H.	Mrs. Margret Louise Rogers	25 Dec 1851 (?)	32
Johnson, Noah	Mrs. Amanda Williams	16 Sep 1852	67
Jones, Benj. W.	Mary Elizabeth Nattin	17 Jan 1854	148
Jones, Briant	Mary J. O'Daniel	30 Apr 1856	223
Jones, James M.	Margaret Reener	6 Jan 1857	247
Jones, Wm. F.	Mary A. Jones (Marino ?)	11 Feb 1857	257
Johnson, Joseph B.	Mrs. Elizabeth V. Tucker	20 Jan 1858	297
Jordan, Frederick N.	Manila Staton	12 Dec 1860	426
Jones, J. W.	Elizabeth Haley	6 Oct 1859	463
Jones, William	Isaredera Pilkinton	6 Jan 1866	502
Johnson, Ed	Many Linkin (? Illegible)	(illegible)	555
Kay, Wm. H.	Harriet Wright	17 Dec 1850	9
Keller, Wm. A.	A. M. Mayers	19 Apr 1854	157
King, Charles R.	Mary R. Lorance	29 Mar 1855	183
Kay, Washington M.	Cerena J. Cochran	9 Jun 1858	312
Key, John	Lucy Amy	27 May 1866	501
Lightsey, John	Mary Elizabeth Urrey	31 Oct 1850	15
Lay, William	Mary West	12 Aug 1850	43
Lewis, E. P.	Mrs. Nancy Liverman	25 Apr 1852	57

BOSSIER PARISH, LA. MARRIAGE RECORDS, BOOK 2, 1850-1867, Cont'd

Lister, Alfred H.	Patience R. Herring	7 Dec 1853	133
Lackett, Coffee	Leraby Malinda Litsey	8 Jul 1854	168
Lockley, Vernon H.	Susan E. Dennard	7 Jan 1855	178
Lawrence, John H.	Eliza P. Applewhite	31 May 1855	191
Littleton, Reubin B.	Willie Ann Lancaster	13 Nov 1856	238
Lay, Isaac	Elizabeth J. Parrot	19 Jan 1856-57 ?	248
Liverman, Wm. B.	Mary P. Williams	6 Jan 1858	293
Looney, Benjamin F.	Josephine P. Frith	27 Apr 1858	307
Love, Thomas M.	Jacaodea Cochran	3 Jun 1858	314
Lee, Jacob	Hannah Williams	12 Feb 1867	499
Lambright, G. W.	L. D. Ponder	12 Jan 1859	344
Logan, J. P.	Marinda Legget	31 Aug 1860	414
Lunsford, Peyton R.	Mrs. Sarah Walters(Signed Sarah Hendricks)	4 Jul 1860	418
Martin, John	Martha E. Spurlin	3 Sep 1851	45
Mitchell, Jacob	Celica R. Childers	24 Feb 1853	87
Mitchell, Jos. H.	Carolin Odom	13 Sep 1853	104
Murrell, Isaac	Elizabeth Rebecca Fuller	7 Dec 1853	123
Moore, Thomas E.	Mary E. King	28 Dec 1854	176
Malone, Drury	Martha A. Montgomery	8 Feb 1855	182
Martin, Thomas B.	Frances J. Ford	9 Feb 1856	218
Malone, Wm. H.	F. Jane Tucker	27 Jan 1856	220
Miller, Austin	Mary J. Steel	1 May 1856	226
May, John W.	Julia E. Love	31 Jul 1856	232
Mabry, Kincher	Nancy J. Davis	5 Feb 1856-57 ?	252
Mason, Laird	Mary F. Strange	10 Feb 1857	254
Malone, W. H.	Christine Hortman	23 Aug 1857	266
Morgan, Richard J.	Nancy A. Statin	8 Oct 1857	269
Miller, Hugh M.	Jane Perkins	19 Apr 1858	304
May, Wm. Z.	Candes High	28 Aug 1858	324
Martin, E. B.	Celia A. Hall	15 Apr 1861	380
Mallory, Lucean	Mrs. Margaret Elizabeth Alden	1 Jul 1862	393
Monzingo, Samuel A.	Catherine P. Hodges	10 Oct 1860	417
Monzingo, G. W.	S. Elizabeth Hodges	5 Dec 1859	473
Moore, Thomas E.	Sarah Jane Harvey	3 May 1859	452
Maples, John L.	N. Emma Suggs	29 Mar 1859	449
Mattison, Wm. T.	Pheby Beard	25 Feb 1866	491
Mincher, A. F.	Margaret M. Grigg	1 Jan 1867	495
Marston, B. W.	Josephine Morse	22 Jan 1867	496
Malone, J. D.	Lou C. Malone	29 Oct 1865	497
McLaughlin, Wm. J.	Julia Ann West, Wid. of Benj. Lay	26 Mar 1851	7
McDonald, James E.	Charlotte Harris	13 Nov 1852	29
McDade, Neal F.	P. E. Sarah Edwards	3 May 1854	155
McFarland, Henderson	Mrs. Ann J. Fuller	14 Feb 1856	214
McAuby, Henry	Willie A. Shaver	21 Aug 1856	239
McWilliams, John C.	Mary A. Smith	24 Dec 1856	243
McDade, D. F.	Sarah E. Walker	2 Jul 1857	264
McDade, James G.	Sallie F. Pope	1 Jan 1861	487
McCullum, Franklin	Emma J. Roberts	7 Sep 1865	488
McAllister, Milton G.	Susan Margaret Talbott	12 Nov 1866	494
Newport, Robt. W., Jr.	Martha E. Dickson	18 Jul 1854	162
Norwell, Thomas J.	Mary Emeline Jones	27 Apr 1858	307
Northcut, W. H.	Lucy J. Martin	2 May 1861	389
Norman, C. B.	Frances Winham	25 Jan 1859	443
Nuckolls, John M.	Exene Wyche	5 Dec 1860	477
Niccum, S. B.	Sarah Ann Lee	24 Jan 1867	490
Odom, Walton	Mary Ann Moore	11 Aug 1853	106
Oglesby, Wm. M.	Elizabeth Jane Lee	8 Nov 1853	118
Oakly, Timothy	Jane Johnson	30 Jul 1857	265
Oliver, Jasper N.	Mary E. Houston	26 Aug 1857	318

BOSSIER PARISH, LA. MARRIAGE BOOK NO. 2, 1850-1867, Cont'd

Oakley, G. W.	Elizabeth Schakleford	1 Sep 1859	402
O'Neill, Patience V.	Mattie G. Gilmore	23 Sep 1863	351
Pinkard, William	Henrietta D. Skinner	19 Jan 1854	139
Powell, Calvin	Elizabeth Black	26 Mar 1854	151
Phillip, John F.	Amanda Johnson	18 Oct 1855	206
Pope, Sidney N.	Sarah F. Connell	22 May 1856	227
Pool, G. A. F.	Elizabeth Jane Bryan	17 Feb 1857	258
Pinkard, James J.	Sarah Pinchard	15 Sep 1857	267
Platt, Wm.	Francis R. King	5 Nov 1857	274
Platt, David	Lucretia A. Springfield	? Dec 1857	287
Platt, Robt. B.	Mary Ann Smith	25 Nov 1862	369
Pope, Green B.	Virginia Connell	1 Jan 1860	487
Pockrus, James R.	Almarinda Boggs	26 Jan 1859	453
Rhymes, Willis A.	Nancy J. Kyle	6 Mar 1851	13
Rymes, John	Elizabeth Sanson	22 Jun 1852	24
Robbo, Bastin	Prudence Floris	21 Feb 1851	39
Rathburn, L.	Mary King	14 Mar 1852	58
Ratcliff, Benj. F.	Almeda B. A. Felps	22 Aug 1852	68
Ross, Johnson	Mary A. Allen	22 Sep 1852	77
Robertson, James M.	Maria C. Dumphey	25 Nov 1852	80
Robinson, John G.	Matilda Skannal	30 Jun 1853	102
Rounsavall, Wm. A.	Mrs. Pauline C. Hayne	13 Oct 1853	115
Rodgers, A. M.	Mary Jane Alden	17 Nov 1853	116
Rodgers, Calvin L.	Loucretia Cook	24 Oct 1855	216
Ray, Thomas J.	Louisa C. Braden	25 Nov 1857	275
Redus, James W.	Leah Magee	29 Dec 1857	290
Richardson, Peter	Martha Ann Ford	24 Jun 1858	317
Richards, John N.	M. J. Lyon	6 Jan 1863	364
Ray, A. B.	Laura Martin	15 Sep 1863	371
Rodgers, James D.	Mrs. Laura A. Holley	20 Jul 1862	392
Rabon, Joseph	Lizzie Doyal	4 Apr 1860	406
Russell, Joseph M.	Mrs. Mary A. E. Felps	8 Jan 1861	434
Robb, John W.	Lizzie Martin	20 Oct 1859	460
Smart, S. M.	Adaline Shaver	16 Jan 1852	3
Slack, Richard	Elizabeth Harriet Tyler	3 Apr 1851	5
Scopine, N. F.	Eleanor Lattier	29 Jan 1852	16
Strickland, Freeman	Pricilla Rhymes	20 Mar 1851	21
Sandidge, Richard S.	Emerline S. Denman	23 Mar 1850	30
Slack, Reuben	Emilie E. Bean	2 Oct 1851	42
Saeverson, James R.	Permelia White	24 Mar 1850	49
Spelling, Frederick M.	Martha J. Ford (widow)	13 May 1852	54
Stinson, Robert T.	Terresa Hamilton	11 Nov 1852	76
Steele, Louis F.	Miss M. F. Saunders	15 Dec 1852	84
Simmons, John W.	Mary S. Wafer	8 Dec 1852	90
Scott, Joseph W.	Catherine R. McDade	9 Dec 1852	91
Sullivan, W. H.	Patience Elizabeth Spears	23 Dec 1852	93
Springfield, Wm. G.	Julia Ann Miller	20 Sep 1853	101
Sanderson, E. S.	Martha R. Graham	17 May 1853	109
Strayhan, James P.	Lucritia J. King	10 Jul 1853	120
Spurlin, Alfred J.	Mary A. Allen	15 Dec 1853	125
Sentell, Geo. W.	Mildred A. Dickson	19 Dec 1853	128
Smith, John A.	Margarett M. Crownover	16 Apr 1854	152
Swindle, Caleb	Mrs. Susan McCullen	24 Apr 1855	186
Spurlin, Albert W.	Isabella Elder	18 Sep 1855	200
Shaver, Alexnader	Louisa Windsor	12 Dec 1855	208
Spellings, F. M.	Martha P. Ford	13 May 1852	230
Strange, John L.	Louisa M. Regon	17 Feb 1857	255
Stiles, Edwin	Elizabeth Allen	11 Aug 1856	276
Shippy, E. A.	Margaret R. Lourance	15 Oct 1857	279

BOSSIER PARISH, LA. MARRIAGE RECORDS, BOOK 2, Concluded on This Page.

Slack, James	Mrs. Mary A. Watkins	19 Dec 1857	282
Springfield, Benj. R.	Martha P. McDade	22 Dec 1857	288
Sanders, John H.	Mary Ann Gregg	2 Feb 1858	299
Simmons, John W.	Seley Strahan	24 Oct 1858	331
Strange E. H.	Nancy A. Young	29 Dec 1858	335
Sanderson, Edward S.	Martha E. Phillips	19 Apr 1858	337
Steuman, Benj. W.	Lizzie G. Taylor	5 Mar 1863	353
Saunders, Thos. J.	Sallie Pope	4 Feb 1863	361
Stacy, A. J.	Anna Lattier	26 Mar 1863	365
Scott, David	S. L. Armor	10 Mar 1863	368
Scott, J. J.	Elizabeth Allen	11 Oct 1859	409
Stewman, B. W.	Mollie J. Stroud	15 Nov 1860	423
Skannal, Able B.	Isabella H. Hamilton	17 Jan 1861	429
Springfield, Benj. R.	E. J. Platt	15 Jan 1861	430
Swindle, John J.	Martha A. Eadens	1 Jan 1861	435
Sledge, James M.	Mary E. McKinney	28 Dec 1859	475
Shaver, Marion	Margarett Thomas	1 Nov 1860	479
Thompson, M. B.	Mary C. Richardson	26 May 1852	62
Twiner, James	Saleta Sapp	6 Jul 1854	162
Tackett, Coffee	F. N. Lightsey	8 Jul 1854	168
Thompson, John S.	Melinda Wells	23 Nov 1854	173
Tyler, Charles	Emily Taylor	13 Sep 1857	268
Twiner, James	Nancy C. Hudson	19 Nov 1857	272
Taylor, Oye J.	Annie Marks	15 Dec 1857	280
Taylor, Septamus J.	Mrs. Adiline C. Walker	4 Nov 1858	332
Thompson, P. B.	Eliza Jane Lawrence	2 Dec 1858	339
Teague, E.	Mrs. Elizabeth Moulder (?)	4 Jun 1863	360
Taylor, K.P.B.	Susan M. McCalla (McCalea)	8 Nov 1861	379
Triggs, J. B.	Mary C. Dickson	16 Apr 1861	384
Thompson, Geo.B.	Sallie E. Burns	27 Dec 1860	431
Tipton, Cebble	Margaret C. Cochran	1 Oct 1859	462
Tipton, Calvin	Tibitha G. Martin	23 Aug 1859	460
Thomas, John	Ann Elizabeth Chckran	17 Mar 1859	446
Thomas, Wm. J.	Marcissia R. M. Shaciford	24 Mar 1859	448
Tummly, J. T.	Mrs. M. R. Cavatt	12 Feb 1864	554
Urrey, Andrew J.	Mary C. Chandler	20 May 1853	98
Underwood, Hugh M.	Catherine S. Shaw	24 Jan 1861	439
Vance, S. W.	Mary B. Gilmer	12 Dec 1854	168
Wallace, M.	Selina Rumbly	8 Jan 1851	74
Williams, James Newton	Martha E. Strange	23 Jan 1852	94
Williamson, Harvey W.	Caroline P. King	24 Jun 1854	160
Wyche, Robert C.	Catherine Hamiter	9 Aug 1854	165
Ward, Benj. S.	Mrs. Sarah A. L. Bonner	8 May 1855	197
West, John N.	Louisa C. Spurlin	7 Mar 1855	219
Westberry, John C.	Isabella S. Wright	10 Jan 1858	296
Willis, Patrick V.	Mary Jane Byrd	12 Aug 1858	326
Worthy, Dr. J. D.	Mrs. M. C. Andrews	28 Aug 1862	396
Wyche, G. A.	Jane Dooly	25 Feb 1862	377
Willson, William H.	Mrs. Julia Ann McGlothen	21 Aug 1862	387
Williamson, Alexander C.	Nancy Hudson	9 Aug 1860	413
Williamson, W. H.	Mary F. Twiner	27 Jan 1860	398
Winham, George	Elmira A. Smith	4 Nov 1860	422
Woodard, George	Matilda F. Malone	12 Jan 1860	485
Wallace, Sevell	Sarah J. L. Perritt	11 Dec 1860	480
Willard, Jacob	Laura A. Yarborough	17 Nov 1859	470
Winham, John	Elizabeth Jane Larkin	22 Mar 1859	451
Walling, Wm.	Sarah Winham	1 Sep 1859	458
Woodward, Thomas	Julia Elizabeth Malone	12 Jan 1860	485
Young, George R.	Mary Sadler	23 Jan 1861	438

*****End Book No. 2*****

DIRECT INDEX TO CONVEYANCES, 1838 - 1860, CADDO PARISH LOUISIANA

Copied by Willie Farley

1849 White, John C., Succ'n	Richard P. Brooks	E-106
1850 White, Wm. B.	F. R. Roach, et al	F-443
1851 White (Whyte), Robt. L.	George W. Martin	G-66
1851 White (Whyte), Robt. L.	J. W. Vance	F-723
1851 White, Wm. B., Succ'n	Elizabeth White	G-254
1853 White, John C., Succ'n	James W. Pegram	H-195
1853 White, Chas. E. J.	L. & M. Blumnethal	H-507
1854 White, Reuben	Robt. Hodges	H-684
1854 White, Elizabeth	Robt. B. Patterson	H-691
1854 White, E. F.	James M. Wilson	I-410
1856 White, Elizabeth	James M. Wilson	I-735
1858 White, Wm. S.	Wm. P. Harrison	L-321
1858 White, Reuben	Leroy McNutt	L-579
1858 White, Mrs. E.	Albert H. Leonard	L-681
1859 White, Thomas A.	John H. Bateman	M-359
1859 White, Beuben	James W. Howard, et al	M-580
1859 White, Reuben	R. A. Crain	N-215
1859 White, Elizabeth	Reuben White	N-493
1851 Whiteman, Walter C.	Levi Perry	F-725
1851 Whiteman, Walter C.	James B. Sims	F-745
1846 Whitfield, F. E.	E. C. Hart	C-605
1851 Whittington, Chas. R.	Angus Currie	F-786
1852 Whittington, Chas. R.	Alfred Attaway	G-410
1843 Whitworth, Benj. E.	E. M. Jenkins	C-165
1848 Whitworth, Benj. E.	Wm. S. & John White	D-115
1848 Whitworth, Benj. E.	Wm. Shaw	H-616 & E-187
1849 Weiner, Theodore	Samuel Isaac	F-77
1853 Wiggins, J. C.	Jonathan Adams	H-109
1853 Wiggins, Mrs. M. M.	D. S. Wilder	H-448
1855 Wiggins, Joel C.	W. M. Folsom	I-375
1856 Wiggins, Joel C.	Reuben White	I-780
1858 Wilbanks, A. G.	M. L. Hines	L-398
1852 Wilder, Joseph	Methodist Episcopal Church So.	H-46 & G-708
1855 Wilder, Joseph, S. A.	John W. Rives	I-201
1856 Wilder, Joseph	Wm. A. Lacey	I-665
1858 Wilder, Joseph	Wm A. Lacey	L-668
1858 Wilder, Joseph	J. S. Williams	M-103
1858 Wilder, David S.	Sephen O. Nelson	M-157
1859 Wilder, Joseph	M. Johnston, et ux	M-679
1855 Wildy, James (Wilder?-Wiley?)	Joel Talmadge	I-461
1852 Wiley, S. B.	L. E. Carter	G-413
1852 Wiley, Sam'l	Sylvester Bossier	G-591
1853 Wiley, S. B.	L. E. Carter	H-327
1849 Wilker (Wilkes?) Geo.	Mrs. Mary E. Land	E-85
1855 Wilkerson, Seaborn	E. C. Crutcher	I-357
1849 Wilkes, Geo	Martha A. Wilkes	E-249
1839 Williams, Henry J.	Wm. G. Beall	A-161
1840 Williams, Henry T.	McCline Barrow, Jr.	A-580 & A-582
1840 Williams, Henry T.	Robt. L. Whyte	A-418
1841 Williams, James	Wm. Perrett	B-15
1841 Williams, B. J.	W. B. White	B-123 & B-236
1841 Williams, B. J. & H. G.	Benj. Ballard	B-184
1841 Williams, James	J. Moats	B-438
1844 Williams, B. J.	Benj. Ballard	C-270
1845 Williams, H. G.	Benj. Ballard	C-389

CADD0 CONVEYANCES - Cont 'd

1847	Williams, Thompson	Alfred Simpson	C-803
1847	Williams, Henry J.	Seth Sheldon	C-909
1847	Williams, Powell	Thomas M. Gilmer	D-49
1849	Williams, James M.	James Harkins	D-549
1849	Williams, W. F.	James Harkins	D-550
1849	Williams, P. C.	J. J. Buford	E-149
1850	Williams, Joseph	John E. Mangan	F-673, F-674 & F-303
1850	Williams, Joseph	Jno. P. Hailey	F-451
1851	Williams, E. D.	A. D. Russell	F-718
1851	Williams, Joseph	Thos. Rowan	G-199
1851	Williams, J. M.	Robert Adams	G-281
1851	Williams, E. D.	A. G. Scoggins	G-311
1852	Williams, Joseph	Ann E. Paul	G-604
1853	Williams, Joseph	John Collins, Et al	G-971
1853	Williams, E. D.	M. J. Loper	H-426
1853	Williams, J. M.	Joseph Attaway	H-484
1853	Williams, C. G..	Wm. H. Daniels	H-508
1854	Williams, J. M.	K. F. Pold	H-576
1854	Williams, C. G.	Thompson P Gray	I-100
1856	Williams, E. D.	Sam Hollingsworth	I-644
1856	Williams, C. G.	Wm. M. Bickham	K-172
1856	Williams, Wm. H.	Joseph H. Kilpatrick	K-340
1857	Williams, Thompson	V. D. Metcalf	L-149
1859	Williams, A. E.	R. A. Cutliff	M-170
1859	Williams, C. J.	Benj. P. Bickham	M-689
1859	Williams, E. D.	John C. Griggs	N-77
1838	Williamson, Thos. T.	Thos. C. Porter	A-13
1838	Williamson, Geo. E.	Jno G. Green	A-38
1838	Williamson, Thos. T.	Chas. A. Sewall	A-49
1839	Williamson, Thos. T.	Jno O. Sewall	A-117
1839	Williamson, Thos. T.	James B. Pickett	A-123
1840	Williamson, Thos. T.	Rbt. Hamilton	A-338 & A-338
1840	Williamson, Thos. T.	James B. Pickett	A-338
1841	Williamson, Thos. T.	John N. Howell, et al	A-602
1841	Williamson, Thos. T.	Chas. A. Sewall	B-3
1841	Williamson, Thos. T.	William M. Roberts	B-21
1841	Williamson, Thos. T.	James H. Cane	B-28
1841	Williamson, Thos. T.	Francis E. Whitfield	B-177
1841	Williamson, Thos. T.	Washington Jenkins	B-208
1842	Williamson, Thos. T.	Henry M. Shreve, et al	B-428
1842	Williamson, Thos. T.	Alex. L. Vanter	C-5
1842	Williamson, Thos. T.	James B. Pickett	C-49
1846	Williamson, Thos. T.	James Walling	C-530, C-531 & C-595
1847	Williamson, Wm.	Hnery J. Sharpe	C-749
1849	Williamson, Jacob	B. B. Willis	F-23
1850	Williamson, Wm.	Mary Bond	F-345
1851	Williamson, Jacob	B. B. Willis	G-240
1856	Williamson, George	Mrs. Sophia Marx	I-727
1856	Williamson, George	John H. Reynolds	K-140
1857	Williamson, George	L. P. Turner	K-695
1857	Williamson, Jacob	Wm. Wyche	L-260
1858	Williamson, Geo.	James M. Williams	L-502
1858	Williamson, Geo.	Richard A. Cutliff	C-527 & C-592
1858	Williamson, Geo.	Leroy M. Nutt	L-612
1858	Williamson, Geo.	S. C. Prothro	M-155
1859	Williamson, Geo.	R. A. Cutliff	M-618
1859	Williamson, Geo., et al	M. Lattier, et al	N-70

CADDO CONVEYANCES - Cont'd

1848	Willis, B. B., T. G. A.	R. Rendall	D-227
1849	Willis, Robt.	T. G. A. Willis	F-25
1849	Willis, T. G. A.	Laura J. Nicholson	F-26
1850	Willis, John A.	B. B. Willis	F-584
1853	Willis, T. G. A.	Wm. J. Beall	G-927
1854	Willis, B. B.	Henry D. Keith	H-566
1854	Willis, James B.	Wm. McCutchen	I-68
1854	Willis, M. B.	Mrs. B. B. Willis	I-151
1854	Willis, Mrs. B. B., Robert	John T. Gilmer	I-170
1854	Willis, J. B., Laura J.	John T. Gilmer	I-171
1855	Willis, J. B., Laura J	John T. Gilmer	I-198
1855	Willis, Mrs. B. B.	M. C. Turner	K-419
1858	Willis, James B.	Robert L. Gilmer	L-643
1858	Willis, Laura J.	James B. Willis	N-135
1859	Willis, Laura J.	John Hendrick	N-135
1842	Wills, James	F. R. Roach	B-497
1847	Wills, James	M. M. Wise, et al	C-895
1847	Wills, James	F. R. Roach	D-425
1849	Wills, James	Margaret Cummings	F-101
1850	Wills, James, Succ'n.	John P. Hailey	F-578
1850	Wills, Martha	L. K. Griggsby	G-250
1853	Wills, James, Succ'n.	Anthony Maghee	H-1
1853	Wills, Wm.	L. K. Griggsby	H-280
1853	Wills, James, Succ'n	E. C. Hart	H-113, H-204, H-375
1853	Wills, James, Succ'n	Robt. Cook	H-226
1854	Wills, James, Succ'n	Wm. Bird	H-718
1839	Wilson, John R.	Sam'l L. Wilson	A-206
1839	Wilson, Joseph H.	John Lott	A-248
1840	Wilson, Sam'l C.	Chas. G. Kerchwall	A-270
1842	Wilson, Nancy	John Lott	B-490
1844	Wilson, James M.	Jesse J. Yearlock	C-175
1845	Wilson, James M.	Wm. C. Shaw	C-309
1847	Wilson, J. H.	Wm. Wynn	C-829
1848	Wilson, J. C.	Lewis Corzine	D-164
1848	Wilson, J. McD.	E. S. Fortson	D-279
1848	Wilson, Thos. D.	J. B. Thompson	D-537
1848	Wilson, J. H. & J. C.	R. T. Noel	D-539
1848	Wilson, Thos. D.	R. T. Noel	D-540
1848	Wilson, J. C. & James H.	Joseph B. Thompson	D-542
1848	Wilson, J. C.	James McD. Wilson	D-545
1848	Wilson, J. C.	Wm. A. Pegram	D-551
1850	Wilson, J. C., R. D.	Thos. E. Adams	F-266
1850	Wilson, Sam'l D.	Robt. S. Wilson	F-336
1850	Wilson, James H.	T. T. Fowler	M-430
1850	Wilson, Robt. S.	David Rodden	F-431
1850	Wilson, John H.	J. N. Howell, et al	F-537
1850	Wilson, James H.	Samuel D. Wilson	F-592
1851	Wilson, Robt S. & Thos. D.	David Rodden	F-701
1851	Wilson, J. C.	Robt S. Wilson	F-802
1851	Wilson, Robt. S.	David Rodden	G-34
1852	Wilson, J. C. & J. H.	R. S. Wilson	G-391
1852	Wilson, J. C. & James M.	J. J. Yealock, et al	G-450
1852	Wilson, Robt. S.	David Rodden	G-455
1853	Wilson, Anna	B. R. Attaway	H-441
1854	Wilson, Anna	W. Cole	H-548
1855	Wilson, James M.	P. F. L. Frank	I-390
1857	Wilson, John H.	F. C. Talbert	K-529

CADDO CONVEYANCES - Cont'd

1858	Wilson, James H.	Wm. B. Thomas	Don. A-67
1858	Wilson, Alfred	Ann Pitts	L-420
1858	Wilson, J. H.	Wm. M. Folsom	L-682
1858	Wilson, J. H.	Henry J. G. Battle	L-796
1858	Wilson, Rose	T. D. Wilson	M-48
1858	Wilson, J. C. & J. H.	Thos. D. Powell	M-122
1859	Wilson, J. C. & J. H.	E. T. Hearne	M-181
1859	Wilson, John H.	Wm. M. Solsom	M-305
1859	Wilson, John H.	W. M. Deloach	M-512
1859	Wilson, James M.	L. M. Nutt	M-514
1859	Wilson, Ann	John F. Thompson	N-93
1857	Winans, W. P.	R. T. Buckner	L-258
1858	Winans, W. P.	V. S. & T. Ry. Co.	L-545
1858	Winans, W. P.	Mary E. Roysdon	L-551
1858	Winans, W. P.	Benj. M. Johnson	L-728
1859	Winn, Walter O.	Leroy Templeman	M-620
1859	Winn, Richard - Heirs	Leroy Templeman	M-620
1852	Winter, Henrietta	J. H. Lengsfield	G-863
1856	Winter, A.	Harriet Cohn	K-305
1848	Wise, Joseph S.	L. D. Nash, et al	D-181
1848	Wise, M. M.	Joel Talmadge	D-288
1848	Wise, M. M.	David Butler	F-290
1854	Wisenor, Wm. B.	Jeanette Renoy	H-739
1854	Wisenor, Jane	Ann M. Deal	I-26
1857	Wisenor, J.	Leroy M. Nutt, et al	L-41
1858	Wisenor, Wm. B.	Heirs of Mrs. M. Bell	L-633
1858	Wisenor, Wm. B.	Robert L. Gilmer	M-13
1859	Wisenor, J. - Succ'n	Wm. M. Folsom	M-635
1859	Wisenor, Wm. B.	Wm. M. Folsom	M-462
1854	Wolfe, Aaron	Amelia M. Wolfe	Don. A-26 & H-779
1855	Wolfe, Aaron	Benj. M. Johnson	I-302
1839	Womack, A.	B. F. Adams	A-111
1840	Womack, A.	Robt. P. Baker	A-444 & A-445
1841	Womack, A.	Wm. Davenport, et al	B-11
1840	Wood, James C.	Sam'l Black, et al	A-541
1840	Wood, D. B.	A. Frame	H-645
1846	Wood, James	Martin Wood	C-604
1846	Wood, James - Succ'n	John Adger	C-681
1847	Wood, James	U. S. Marshall	C-786
1847	Wood, G. J.	Alex McLean, et al	C-787
1847	Wood, Robt. N.	Henry & Samuel Vanbibber	D-17
1848	Wood, Robt. N.	James Pierce	D-42
1849	Wood, Robt. N.	E. R. Olcott	D-372
1849	Wood, Robt. M.	John Young	E-183
1849	Wood, Green	Wm. H. Lindsey	F-117
1850	Wood, Robt. N.	Allen Hill	F-137
1850	Wood, Robt. N.	Robert Green	F-207
1850	Wood, Robt. N.	Mary E. Land, et al	F-362
1850	Wood, Robt. N.	Wm. N. Head	F-365
1852	Wood, James - Succ'n	James Marks	G-819
1853	Wood, W. H.	James Marks	H-262
1853	Wood, Jas. C. & Catherine	Mary Cargile	H-420
1853	Wood, John	David I. Hooks	H-51
1853	Wood, James E.	Catherine B. Cargile	H-421
1854	Wood, Eldred	Mrs. Margaret E. Enos	I-163
1854	Wood, A.	W. C. Wood	Don. A-29
1854	Wood, Wm. C.	R. A. Cutliff	I-165

CADDO CONVEYANCES - Cont'd

1854	Wood, Eldred	Rebecca J. Wood	Don. A-29
1856	Wood, James - Succ'n	Jno. W. Simmons	K-319
1857	Wood, Mrs. R. J.	Mrs. Margaret O. Enos	K-508
1857	Wood, F. E.	Allen A. Enos	K-509
1858	Wood, James - Succ'n	John Adger	L-318
1858	Wood, Martin - Estate	James Marks	L-732
1858	Wood, T. & W.	James Marks	L-732
1857	Woodruff, E. M.	Frank A. Ragsdale	L-645 & L-635
1857	Woodruff, E. M.	Andrew Stacy	N-976
1854	Woodson, Wm.	Chas. G. Young	I-23
1855	Woolridge, Mary (Woldridge)	Mrs. E. P. Robinson, et al	I-307
1855	Woolridge, Mary	Woolridge, Jordan & McCollough	I-34
1857	Woolridge, John C. - Heirs	Joseph C. Beall	K-608
1859	Woolridge, Elizabeth	Josephine McCullough, Minor	Don. A-73
1856	Wooten, Spencer	Leroy Bennett	I-628
1855	Wornum, C. P. & Wm. L.	George T. Hurt	I-532
1855	Wornum, C. P. & Wm. L.	Wormley Rose	I-385
1840	Wright, Isaac	E. Cannon	A-435
1844	Wright, M.	F. R. Roach	C-188
1850	Wright, Allen R.	M. Watson	F-223
1854	Wright, James W.	Alfred Morse	H-345
1854	Wright, N. E.	John Lowe	N-59
1859	Wright, N. E.	Joseph B. Young	N-59
1849	Wyatt, Wm.	Robert W. Legrande	E-101
1856	Wycle, John F., Jr.	James S. Sanderson	L-1
1852	Wylie, Samuel	S. Bossier	G-591
1854	Wylie, Anne C.	J. C. Beall	I-120
1855	Wylie, E. S. - Succ'n	Esther Wylie, et al	I-577
1855	Wylie, E. S. - Heirs	Frs. of Ebenezer Church	I-578
1855	Wylie, E. S. - Heirs	Themselves	I-577 & I-559
1856	Wylie, James D.	E. C. Bickham	K-131
1859	Wylie, James D.	Riley T. Surratt	M-415
1859	Wylie, Ester - Succ'n	James D. Wylie	M-417
1854	Wyndham, James C.	James B. Gilmore, et al	I-168
1848	Wynn (Wynne), Wm.	Jessie Yealock	D-147
1848	Wynn, Wm.	B. S. Dickson	D-153
1851	Wynn, Wm. L.	R. W. Godwin	G-100
1856	Wynn, Wm. L.	Matthew Watson	K-690
1858	Wynn, Robt. H.	William Shaw	M-28
1847	Yarborough, Stephen	Mcihael Dickson	C-769
1849	Yarborough, J.	Thos. Arthur	E-217
1848	Yealock, Jesse	P. J. McCarty, et al	D-159
1849	Yealock, Jesse	John C. Murphy	D-514
1849	Yealock, Jesse	Emily A. Duke	D-548
1849	Yealock, Jesse	John B. McFarland	E-148
1850	Yealock, Jesse	B. B. Smith, et al	F-267
1850	Yealock, Jesse	Jesse Yealock	F-276
1850	Yealock, Jesse	Sam Bloodworth	F-386
1851	Yealock, O.	Jesse J. Yealock	F-744
1851	Yealock, Jesse	G. D. Bludworth (Bloodworth ?)	G-84
1851	Yealock, Jesse	Willie Pollard	G-103
1852	Yealock, Jesse	O. Yealock	G-597
1852	Yealock, Jesse	Wm. J. Jones	G-804
1853	Yealock, O.	Emily A. Duke	H-501
1854	Yealock, J. J.	Wm. P. Harrison	H-522
1854	Yealock, Franklin	W. W. Harper	H-589
1854	Yealock, J. J.	Wm. J. Jones	M-457

CADDO CONVEYANCES - Contd.

1846	Young, P. S.	John W. Compton	C-564
1848	Young, Chas. G.	Greenwood Town Company	D-154
1848	Young, Chas. G.	Wm. Jones	D-162
1848	Young, John	John S. Rowland	D-299
1849	Young, Chas. G.	R. E. Curlee	D-524
1849	Young, John	Martha Gooch	F-18
1849	Young, C. G. & M. G.	Samuel A. Jones	F-377
1851	Young, John	F. McMahon	F-741
1851	Young, John	E. H. Jordan	F-800
1851	Young, Chas. G.	W. W. Harper	G-9 & G-11
1851	Young, John	John Young	G-233 & G-232
1851	Young, John	Nancy H. Hotchkiss	G-288
1851	Young, John	F. R. Roach	G-287
1851	Young, Chas. G.	L. T. Eppes	G-340
1852	Young, John	John Collins	G-802
1852	Young, John	W. R. Carter	G-803
1852	Young, Richard - Estate	N. M. Gilmer	G-881
1853	Young, Martha R. - Succ'n	Wm. H. Bayliss	H-74
1853	Young, Martha R. - Succ'n	John Thatcher	H-74
1853	Young, Martha R. - Succ'n	Richard T. Buckner	H-134
1853	Young, John	V. H. Jones	H-97
1853	Young, John	John Young	H-213
1853	Young, John	Daniel Waddill	H-258
1854	Young, John	Mrs. H. Hotchkiss	H-717
1854	Young, Pricilla	Geo. W. Robinson	I-61
1854	Young, Pricilla	Joseph Beaird	I-62
1854	Young, John	W. F. Murray	I-104
1854	Young, Chas. G.	Louis T. Eppes	I-124
1854	Young, Chas. G.	Benj. E. Brooks	I-125
1855	Young, John	Mary D. Alexander	I-352
1855	Young, John	Rich. T. Buckner	I-523
1856	Young, Chas. G.	Richard A. Cutliff	I-681
1856	Young, Chas. G.	John B. McFarland	I-683
1856	Young, Chas. G.	Mickael Mulhall	I-688
1859	Young, Chas. G.	Wm. A. Pegram	M-662
1847	Youngblood, Benj.	A. B. McMillan	C-708
1848	Youngblood, James	Robert E. Davis	D-32
1855	York, Ann C.	Ebenezer Church	I-578
1855	York, Ann C.	Esther Wylie	I-579
1859	York, Willis M.	Flavel Foster	M-165
1859	York, Mrs. A. C.	Flavel Foster	M-179

This completes publication of the Direct Index to Caddo Conveyances 1838-1859, Deed Books A thru M. Names of the buyers in the second column far exceed the names of the sellers in column No. 1, because many of these sellers owned huge tracts of land and many buyer purchased only small tracts.

For prompt information as to number of pages and cost of zerox copies of any Caddo Parish Conveyance published in The Genie, send self-addressed stamped envelope with year, name of seller, name of buyer, book and page number to:

Mr. Dwight D. Pyburn (ATTN. Mrs. Dollard Berry)
 Clerk of Court - Caddo Parish Louisiana
 P. O. Box 1833
 Shreveport, Louisiana 71102

Some of these transactions involved many pages, especially Successions and Estate Settlements, so be sure to include all Book and Page numbers in requests for information.

WHAT OTHERS ARE DOING

This section of The Genie includes news on activities of other organizations of the south and southwest, review of periodicals, announcements of special meetings, Workshops, publications and other data of interest in our area, but no commercial type ads. All Genealogical-Historical groups are most cordially invited to send in their news releases for publication in this section.

* * * * *

GENEALOGICAL EXHIBIT AT LSU LIBRARY: Display windows in the foyer of LSU Library, Baton Rouge, are available to Wm. King Hunt for all of April. This will include display of books, quarterlies, brochures, announcements and other data from sever-genealogical organizations, including the Ark-La-Tex Genealogical Association, which Mr. Hunt so graciously accepted by last minute arrangement.

* * * * *

FOURTEENTH ANNUAL INSTITUTE
of the
LOUISIANA GENEALOGICAL & HISTORICAL SOCIETY
Saturday, 17 April 1971
Capitol House Hotel - International Room
Baton Rouge, Louisiana
Registration starts at 8:30 a.m.

Program Includes

Tour of the Department of Archives of the Catholic Diocese of Baton Rouge,
Conducted by Mrs. S. J. Gianelloni, Archivist.

Workshop (a class) for beginners and assistance in Genealogy.

Speakers: Wm. King Hunt, Librarian at LSU Branch of the Salt Lake City
Genealogical Library.

H. M. "Jerry" Doty, Shreveport, La. - "The Ethnic Population
Movements in Early Louisiana."

General Meeting: Announcements, Election & seating of officers, Adjourn 5:00 p.m.

NOTE: Will anyone in the Shreveport-Bossier area planning to attend this meeting, please call E. M. Tipton, 423-6983, any time, or Ema Lee Tipton, 8-5 week days, at 424-0956. THIS IS URGENT.

* * * * *

ANNUAL GENEALOGICAL INSTITUTE & WORKSHOP
of the
LOCAL HISTORY AND GENEALOGICAL SOCIETY, DALLAS, TEXAS
Saturday, 15 May 1971
El Centro College - Dallas, Texas

Lecturers: MRS. MARY BONDURANT WARREN, Danielsville, Ga., editor and publisher of the Georgia Genealogist, Carolina Genealogist, Heritage Papers, and Family Puzzlers, will discuss research in the Carolinas and Georgia.

MRS. INEZ WALDENMAIER, Washington, D.C., member of the staff of the National Society Daughters of the American Revolution, will discuss research in southwestern Pennsylvania, Virginia, Arkansas and Washington.

For further details and reservations write to: Mrs. Pauline Welch, 2706 San Marcus, Dallas, Texas 75228.

At the Ft. Worth Workshop, E. M. Tipton invited half the audience to attend the Ark-La-Tex Genealogical Workshop to hear Milton Rubincam on May 15, and Jeane Lush invited the other half to come to Dallas.

DESOTO PARISH HISTORIC TOUR

Sponsored by

DeSoto Parish Historical Society

and

National Society of Colonial Dames of America

in the State of Louisiana

April 23 - 24 - 25, 1971

Hours: 10:00 a.m. to 5:00 p.m. Friday & Saturday

1:00 p.m. to 5:00 p.m. Sunday

RED TOUR

Stonewall-Gloster

Mrs. Hal Means

Chairman

BLUE TOUR

Keatchie

Mrs. Frank Scheller

Chairman

WHITE TOUR

Mansfield

Mrs. Clara Best

Chairman

Each Tour: \$3.00. Brochure & map available from Tour Chairmen or DeSoto Parish Historical Society, Box 743, Mansfield, La. 71052, and in local newspapers.

Mr. & Mrs. Gene Lush have presented the microfilm of "KEATCHIE COLLEGE REGISTER - 1883-1911" to the Genealogy Room of Shreve Memorial Library. The old original register was discovered at Fairview Plantation during the DeSoto Historic Tour last year, and is owned by John T. Moseley III, of Fairview, on the Blue Tour this year. Keatchie College was established in 1852 and attended by sons and daughters of many prominent early northwest Louisiana and East Texas families. It was absorbed into Louisiana Baptist College after 1911, and while earlier records have not been located, this last register gives the name of the student, parent or the guardian and residence, and identifies many early settlers of this area. It is very important genealogically and historically. Libraries, Archives, Colleges and individuals may order this microfilm from LUSH CUSTOM MICROFILM, 2737 O'Bannon Drive, Dallas, Texas 75224, for \$4.00 postpaid.

SONS OF CONFEDERATE VETERANS

W. H. Rutledge

Recently, a group of dedicated descendents of Confederate Veterans met and reformed a Camp of Sons of Confederate Veterans in Shreveport, Louisiana, to help perpetuate the priceless southern heritage left behind by those valiant Men in Grey.

Originally, the true Confederate Veterans themselves had their own Confederation of members that numbered into the thousands. As their ranks began thinning with age, the sons of these patriots took up the Banner to keep alive the principles for which these men fought and so many made the supreme sacrifice. Today, there are precious few who are true Sons of the Confederacy, but there are untold thousands of grandsons, great-grandsons, grand-nephews, and others who, by lateral or collateral descent can trace their relationship to a Southerner who wore the Grey of the Confederacy.

One of the noteworthy projects of the Sons of Confederate Veterans is to help maintain with funds, the Home of Jefferson Davis, "Beauvoir", on the Gulf Coast, for here lies the heart of the Confederacy through posterity for all to see and appreciate.

This new Camp, through its elected officers, urges all male descendents of Confederate Veterans, 12 years of age or older, to contact the Camp's Commander or any member they may know and make application for membership.

CAMP COMMANDER: W. H. Rutledge, 120 Robert E. Lee Place, Bossier City, La. 71010

CHURCH AND CEMETERY REUNIONS

Church Services and Special Programs begin about 10:00 a.m. at each of these, followed by the traditional feast of basket lunches spread on long tables, with every one going around selecting what he likes best, visiting with relatives and friends he hasn't seen since last "homecoming" and cameras and tape recorders work overtime, while genealogy is the major topic of conversation the entire day.

18 April 1971: ROCKY MOUNT CEMETERY, near Ringgold, Bienville Parish, La. The beautiful little old Church building was burned by arsonists last fall, but a big tent will be provided for the "homecoming" this year. This is old Alabama Bend, and early settlers were named FRANKLIN, BURKETT, KIRKPATRICK, MAYFIELD, MOSELEY, LOCKE, TIPTON, NETTLES, SCOTT, McCOY, BATES, CRUMPTON, GREEN, SKIPPER, SLEDGE, TOOKE, WIMBERLY, HALL, VICKERS, HALL, HUCKABAY, and others too numerous to list.

2 May 1971: SPRINGHILL BAPTIST CHURCH, near Ringgold, Bienville Parish, La. A fine modern building replaces the old one, with the ancient cemetery not greatly enlarged. Settled by same families listed above. Old Post Office was MANNING, LA.

2 May 1971: GROVE HILL CEMETERY (Old Double-Churches), off Mansfield-Pelican Hiway, near Fire Tower in DeSoto Parish. First grave about 1850, and early settlers were named CARROLL, ETHEREDGE, MASON, MOORE, MASON, NANCE, SMITH, WILLIAMS, et al, most from Alabama.

* * * * *

VIRGINIA WORKSHOP
Fort Worth Genealogical Society
Saturday, 27 March 1971

About 175 eager listeners head Dr. Virginia Pope Livingston lecture on Research in Virginia, including surrounding areas of Maryland, the Carolinas and Tennessee. All those who had attended the Institute of Genealogy at Samford University knew what to expect, but for the uninitiated, like me, this was an experience we will never forget.

Dr. Livingston's training, skill, experience and reputation are well known throughout America, but little has been said of her charm, wit, fabulous memory for dates, names and places, generous compliance to the demands of her audience, or her amazing stamina. Many were so hungry for information they kept her talking for seven hours, even during coffee breaks and lunch crowding around her with questions on almost every possible phase of genealogy and research. Most of us would have just dropped dead with fatigue long before 4:30 p.m.

We were promised "a very rewarding day." It was that and more. We congratulate Fort Worth on their well planned successful Workshop, and bow to the brilliant, gracious lady who made it so very rewarding for all who came to hear her lecture.

* * * * *

LUFKIN GENEALOGICAL & HISTORICAL SOCIETY
Annual Genealogical Workshop
Lufkin, Texas 27 March 1971

Lufkin always has a fine program for their workshops with a large attendance. This was no exception. The Banquet Room of Holiday Inn was filled to capacity. Outstanding lecturers, good fellowship, a fine luncheon and other features set a precedent for Workshops all over the country that will be hard for others to follow.

YOU CAN'T DO IT ALL AT ONE TIME

Ema Lee Tipton

In Nonsense Novels Stephen Leacock tells of a hero who jumped on his horse and dashed frantically off in all directions at once. Some searchers take this same approach to genealogy, then complain bitterly that they never get anywhere. If you suggest they slow down, get better organized, and try concentrating on only one or two lines at a time, they ignore you or hurriedly explain they can't since they need proof that some ancestor came over in the Mayflower, to Virginia before 1700, or fought in the Revolution in order to join some society at once, or establish their descent from royalty - and any old ancestor who qualifies will do.

A friend told me that she left home at 7:00 one morning, went through all the old courthouse records in Red River, Natchitoches, Sabine and DeSoto Parishes but found nothing and didn't get back home until 5:30 p.m. - that same day. With about six hours for driving and coffee breaks, she barely had time to go through the courthouse buildings, locate offices where the records were kept, and perhaps to check a few indexes. She certainly didn't have time to "go through" all the old records, but she was in a real big hurry.

A cousin wrote that she was taking a two-week trip through Texas, Louisiana, Mississippi, Georgia, the Carolinas and Virginia and expected to locate all the records on 34 of her families scattered throughout all these states. She returned blaming courthouse and archives personnel for her failure to find more than a few scraps of data, saying she had spent at least an hour at each courthouse and State Archives where she knew some records should be, and couldn't imagine why she failed to find them. My cousin must have inherited her imagination and common sense from her mother's side of the family - not from mine.

To attempt research on all your families at one time is a mistake. If you are a good juggler, perhaps you can keep your grandparents, even great-grandparents, all up in the air at the same time, but beyond that, NEVER! Note even if you are psychic, agile as a cat, have a photogenic mind, perfect health, the stamina of an ox, nothing else to do, and someone to help you full time 36 hours a day! Not even Merlin, the magician of King Arthur's Court, could pull all his ancestors out of the past at one time. Not even Houdini could do that.

Just try it and before long you will be climbing imaginary family trees right in the middle of your padded cell, perching on a limb and crying, "Grandpa Jones-Smith-Brown-Turner-Williams! Grandpa What-Ever-Your-Name-Is, where are you?"

So you started late, most of your older relatives are gone, you are past 40, getting no younger, days growing shorter, weeks passing faster, you don't have 100 years to find all the records on all your ancestors - and you want them ALL. That would be nice, but haven't you heard of those poor souls who want ice water? Or that little snowball's chances of survival in the summer sun? Your chances of ever finding all the records on all your ancestors, or even all your ancestors, are much slimmer than these, so concentrate on those you can find - one or two at a time, straight back, one or two steps at a time.

Don't give up hope of finding the others, but let them wait until you get to a stopping place or up against a blank wall on those you're working on, then start on one or two more. Don't waste time jumping from place to place, family to family, never looking to see where you are going or where you have been, and never taking time to just sit down and think things over and plan your next step. I spent the first two years of research chasing 23 families all over the south and southwest without too much success, then another year untangling the records and separating them into small closely related groups to be concentrated on one at a time. Since then, almost every hour of research has been an hour of progress. When I get stopped on one, I simply go to another with no difficulty or delay. Don't destroy yourself by trying to go in all directions at once.

ABSTRACT OF WILLS OF BIENVILLE PARISH LOUISIANA

1850 - 1932

ARCADIA, LOUISIANA

Copied by Mrs. Vernon Honley

ENTRY PAGE NO.

I. 1 PETER E. BOZEMAN, 29 March 1850.

Will opened by Clerk of Court, John F. Stephens, May 9, 1850. Application by wife Gillandezzer Bozeman. Proven by William W. Colbert, John Floyd Phillips and Richard Colbert. Recorded May 10, 1850 by John F. Stephens, Clerk. Six Children: James Thomas Bozeman, Jesse Porter Bozeman, Sarah Jane Bozeman, Mildred Ann Oliver Bozeman, Polly Ann Eliza Bozeman and Edward Peter G. Bozeman. Witnesses: Barthaw Egan, John Floyd Phillips, Wm. W. Colbert, Richard C. Colbert, Mary E. Colbert.

II. 5 BERRY A WILLSON - Deceased 1846

Testator: Berry A. Willson deceased 1846, Executrix: Wife Elizabeth Willson resided in Claiborne Parish, 17th Judicial District, since formed into Bienville Parish. Signed: Geo. W. Peats (Putz) Atty., Clerks Office Sparta Dec. el, 1850 John F. Stephens, Clerk of District Court.

Nov. 4, 1846 - 71st year of Independence of U.S.A. Berry A. Willson moved from Claiborne Parish to New Orleans, La. I, the undersigned Amedee Ducatel, Notary Public, residing and accompanied by witnesses Mrs. James Monroe Wolfe, Matthew Cordann and Edward and Follansbe did go to the dwelling house of Berry A. Willson on Baronne St. between Canal and Common St., boarding house of Mrs. W. Howard:

WILL: "Sick of body but sound of judgement and mind, my name is Berry A. Willson, 53 years 4 months, no children. I give and bequeath to my wife, Elizabeth Thompson all of my property, real estate and slaves." Executrix: Wife Elizabeth Thompson, Executor: Mr. James Thompson of Claiborne Parish. Signed: Armedes Ducatel,
Notary Public.

III. 11 MESHACK MATTHEWS, 7 January 1851, 27 February 1851

Petitioner: William Taylor, trusted friend, Thursday at 11 o'clock, Feb. 21, 1851. Hon. Roluns Jones, Judge, 17th Judicial District Court. John F. Stephens, Clerk. Rowland L. Horn signed. Roland L. Horn declared he knew the signature of Meshac Matthews. February 27, 1851. Hillary Logan affidavit he knew Meshack Matthews. March 10, 1851 William W. Poland, February 27, 1851, Affidavit he knew Meshac Matthews. Wife Sarah Matthews. Witnesses: Elihu Woodall, John H. Taylor, Wm. W. Poland, Hillary Logan, R. L. Horn. March 31, 1851, J. F. Stephens, Clerk.

IV. 12 MARTHA L. PIPKIN, 3rd Day of March 1852

Also Martha L. Lewis who was the late Widow Goodson, last wife of Shadrack W. Pipkin of State of Texas. Daughter Mary Elizabeth Goodson. Lawson and Fuller Attorneys for petition. Recorded May 27, 1852 at Sparta, John F. Stephens.

Washington Co., Texas, April 5, 1852, present William A. Higgins, Chief Justice, John H. Day, Sherriff, Saul Lusk, Clerk. Present and declared signature April 6, 1852. John H. Money, Keneben A. Lewis. March 6, 1852, Affidavit of John F. Key and T. S. Veasey. April 6, 1852 W. A. Higgins, Chief Justice.

WILL: "Martha A. Pipkin gave to her daughter Mary Elizabeth Goodson her negro girl Louisa and one-half of all remaining estate after legal debts are paid. To my beloved husband Shadrack W. Pipkin one-half estate and guardian of daughter during her minority and reside with mother Elizabeth Lewis. In case daughter dies without giving issue, her part of possessions goes to my mother if living. March 3, 1852. Washington Co. Texas." Shadrack W. Pipkin, Parrott W. McNess and Simpson W. Minn gave bond of \$5,000.00 as security April 7, 1852.

BIENVILLE PARISH WILLS:

ENTRY PAGE NO.

V. 19 GEORGE COOK, July 1845, Died Laurens Sounty South Carolina.

Petitioners: Sons Joshua and James E. Cook, and their mother Polly Cook. Will Probated in Laurens County South Carolina, the place of death of Testator. Since his death the petitioners removed to Bienville Parish, La. Daughter Elizabeth Knight deceased and to whom was left a negro boy Toby. In the interest of the children of deceased sister the petitioners request that an inventory be taken and they be allowed to act for the general relief of said children. Signed: Joshua and James Cook, September 15, 1853. J. F. Stephens, Clerk.

Toby the negro boy valued at \$325.00 to be sold and divided among bodily heirs of Elizabeth Knight. Certified copy os will dated August 2, 1853, Laurens District, South Carolina signed by W. D. Watts, Esq. Will Book page 58. John Garlinton, clerk. Children of George Cook: James, Joshua, Nancy, Allen B., John, William, E. Mary, Martha, Abraham and George each to get \$325.00. Joshua to see after the interests of Elizabeth, July 3-, 1845, the Seventieth year of Independence of the United State of America.

Witnesses for petitioners Joshua and James Cook are J. J. Atwood, R. Thomas and William Rose.

VI. 22 JAMES AMBROSE, 5 December 1853 - Succession - No Heirs.

Petitioners: John Brice and Jane Brice his surviving wife. W. B. Egan Attorney for petitioners. Order: November 16, 1853, the will be opened at the store of C. G. Thurmond in the town of Mount Lebanon, Bienville Parish, La. on Monday, Nov. 28, 1853. Jane Brice to be notified. Affidavit: William G. Key knew James Anbrose handwriting. Signed: Jacob Cook, November 28, 1853.

WILL: "To Daniel Henderson of Texas, son-in-law of James Brice, Senr., I give one note on William C. Copes due first day of November next \$650.00. Balance I give to John Brice son of James Brice and brother-in-law of Daniel Henderson consisting of note on Thomas Leatherman for \$70.00, one note on Dr. James C. Egan \$30.00. My interest in a note on Jincher in hands of John Key, Dr. J. Egan witness. Ten acres land deed from Dr. Eagan to Dr. Coters, further I give him all the whiskey and other groceries in my possessions, also trunks and wardrobes, reserving the best to be buried in. I want no sheet. Last \$125.00 in cash, a note on Wm. C. Copes due for \$50.00 to said Brice. Conditons if I die within a reasonable distance of the place, I want to be deposited on the right hand hill going east at Tarkington's Gap in a good substantial vault of brick so that I shall rest two feet above the ground. Brice to have a coffin made of good workmanship worth \$25.00. If Brice carried out these, all is right, if not all will go to Daniel Henderson after paying expenses. My intentions were to leave until lately to Jane Brice part of what I posses but lately her course toward me forbids it." Dated 19th July 1853, filed 28 November 1853. Recorded at office a Sparta by J. F. Stephens, Clerk.

VII. 27 WILLIAM WATTS, 7 January 1854

Petitioners: James A. Watts and William B. Watts, W. E. Paxton, Attorney for petitioners. Affidavit of witnesses: John N. Martin, 18 January 1854; Daniel Batchlor 7 January 1854. Henry L. Jones signed Watts mark. Written by John N. Martin.

WILL: "I give to my beloved wife, Margaret Watts, named slaves Malinda, Lucinda, and Minerva. And South $\frac{1}{2}$ of Southeast $\frac{1}{4}$ of Section 36 Twn. 16, R 9 and North $\frac{1}{2}$ of N.E. $\frac{1}{4}$ of Section 1 of Twn. 15 R 9, my wagon and mules and plantation tools, cattle and hogs during her lifetime but after her divided between four children: James A., William B., Joseph, and my daughter Mary F. Horse.

William to get North $\frac{1}{2}$ of N.W. $\frac{1}{4}$ Section 1 Twn. 15 R9.

James to get South $\frac{1}{2}$ of S.W. $\frac{1}{4}$ of Section 26 Twn. 26 R 9.

Mary to have S.E. $\frac{1}{4}$ of Section 15 TWN 16 R 9.

- Cont'd next page -

BIENVILLE PARISH WILLS - William Watts, Cont'd

Joseph to get West $\frac{1}{2}$ of N.W. $\frac{1}{4}$, N.E. $\frac{1}{4}$ of N.W. $\frac{1}{4}$ Section 23 Twn. 16 R 9 and \$100 in cash.

James and William B. appointed to be executors." Witnesses: John Waters, Peter Waters. Original signed by N. E. Vanetur (Varetur). Opened 7th January 1854. Recorded by John F. Stephens, Clerk. (Continuation of this estate on Page 134, Bienville Parish Will Book, will be published later if it contains more data on this family.)

VIII. 34 JOSHUA MELVIN, Died 14 November 1854

Petitioners: Jacob Evans, James Bryan and James Vickers.

Joshua Melvin departed this life November 14, 1854, left two children George W. and Eliza Jane Melvin. W. E. Paxton, Attorney. Order: At Sparta, opened and read November 23, 1854. Proved December 23, 1854. Three witnesses: James J. Vickers, Jr., M. W. D. Cawthon, and Luke Albritton. James J. Vickers appointed Tutor. Commission issued to W. B. Steivan (Steiner ?), Notary, 23 November 1854.

WILL: "Dated November 18, 1854. \$600.00 to the two children and two things (?). Balance of the estate to wife Elizabeth, and one thing (?). After wife's death all goes to children." Signed: W. M. D. Cawthon, John Dennard, J. D. Cawthon, Howell Albritton, James J. Vickers, Jr., and Luke Albritton. Filed November 23, 1854.

IX. 40 ELIZABETH WASHBURN, 28 February 1854

Petitioner: Brother, John A. Washburn. Witness: John Took, voiced by William W. Todd. Affidavit of E. T. Jones and Joshua Melvin as knowing Elizabeth Washburn.

WILL: " I will to my Mother, Anna Washburn, three negro slaves, Lucy Ann, age about 18 years, Angeline age 3, and Leah age 20 months, and their increase if any and after the death of mother, possessions to be divided between sisters and brother: Pricilla now the wife of John H. Cain, Susannah wife of William Rogers and John A. Washburn. I request the rest be sold to the highest bidder, my horse, saddle and bridle, feather bed, bedstead and furniture and pay debts. My Mother to have remainder. I appoint brother, John A. Washburn executor. 28th February 1854." (At the top of page 43, the name N. Evans, Tutor ?). Witness: William Todd, John Took, Edw. T. Jones, Abraham J. Evans, Joshua Melvin. August 14, 1854 J. F. Stephens, Clerk. (Continuation on P. 158 of Will Book will be checked for any additional data on this family.)

In extracting these Bienville Parish Wills and Successions, Paunee Honley has attempted to give names, dates, places, and has omitted most of the non-essential data and the "whereases", "wherefores", "etc's", and detailed haggling over the who-kind-of-whats that have no genealogical significance. Please note most of the nine wills extracted covered an average of five or six pages in the old Will Book. Compiling this type information is slow, tedious work. Everyone stand up and applaud the unselfish labor put forth for your benefit. We thank you, Paunee.

SKETCHES OF MOBILE, published 1868 by Captain Bernard A. Reynolds, a Mobile, Ala. newspaper man, is being reprinted and will be available soon. Except for the addition of Capt. Reynolds photograph, Publisher's Notes, with Introduction and six pages of notes by Benjamin R. Williams of Montgomery, the reprint is a faithful duplication of the original. It will be 5 $\frac{1}{2}$ x8 $\frac{1}{2}$ inches, paper backed, stapled and taped, priced at \$5.95 postpaid. For date of release and other information, write to E. M. Tipton, Rt. 1, Box 403-D, Bossier City, La. 71010.

HAMITER CEMETERY
North of Plain Dealing, La.
Copied by Mrs. James Hamiter

Patience Hamiter, died June 1848, Age 42 years, 6 months, 6 days.
John Hamiter, born 22 September 1802, died 2 February 1864
Sgt. R. E. Hamiter, 26th Arkansas Infantry, Co. G, CSA.
Ella Hamiter, born 28 April 1861, died 6 June 1918.
Joel Biggs Hamiter - Age 8
Baby Emmie Hamiter, born 9 February 1913, died 19 March 1913.
Arene S. Hamiter, Wife of Abe, born 9 January 1894, died 1 June 1928.
Mary F. Hamiter Lowe, born 18 February 1925, died 12 January 1944.
Bertha Winn Hamiter, 1901 - 1933.
David Hamiter, Jr., 1931 - 1933.
Kate Bryant Seward, born 2 February 1884, died 15 January 1916.
Ada May Seward, Wife of A. G. King, b. 31 December 1887, d. 20 February 1926.
Patricia Ann Turner, born 6 August 1953, died 16 June 1954.
Mary Katherine Turner, born 4 January 1951, died 19 September 1951.
W. H., Son of Garland and Ada M. King, born 20 December 1908, died 7 August 1910.
Aunt Hattie, Wife of J. N. Bryan, born 28 May 1833, died 5 February 1902
Jimmy Impson, born 1 April 1911, died 19 November 1916.
Robert Cox, born 10 March 1923, died 22 June 1925.
Otis Cox, born 20 December 1919, died 28 February 1920
Wm. A. Moore, Co. E, 3rd Texas Infantry - Spanish-American War.
Mary Elizabeth Turner, born 23 January 1888, died 18 January 1953.
Tillman Turner, born 18 February 1922, died 10 November 1950, U.S.N.A, WW II
Wesley Arthur Turner, born 28 September 1888, died 14 June 1963.
Emmie B. Seward, born 7 May 1886, died 21 September 1962.
John E. Seward, born 28 October 1884, died 23 May 1950.
Jewel Dickson, son of John and Emmie Seward.
John D. Casey, born 5 June 1905, died 11 May 1950.
Mary Catherine Dooley Hamiter, born 21 February 1846, died 30 July 1882.

* * * * *

INFORMATION PLEASE

POWELL-TRAYLOR-JONES-BARTON-BASS-BENSON-DAY-THOMPSON-HILL: James Moore Powell b. 27 Feb 1791 "Bartee" (Bertie ?) Co. N.C. d. 27 Feb 1868 Old Waverly, Texas, m. 20 Sep 1822 Marion, Ala. Nancy Jones Traylor b. 1804 Wilkes Co. Ga. d. 1881 Old Waverly, Texas (dau of Champion Travis Traylor and his wife Sarah Jones). Their Children were: Lewis Moore b. 1823 in Ala. moved to Union Ph.La. after 1839; Mary Ann Elizabeth m. Richard Bass, In La. ca 1839, later to Texas; James Henry probably died in his teens buried in La. (where ?); Champion Travis m. (1) in La. Amanda Benson who died age 23 in 1858 buried Marion, La. - had son James Edward who went to Texas, Champion T. m. (2) 1866 in Texas Margaret Barton b. 1832 Farmerville La; John Traylor m. Elizabeth Day and moved to Texas; Dr. William Pentecost m. Mary Eugenia Thompson in Willis, Texas and served in Hoods Texas Brigade CSA; and Sarah Emily b. 1840 Union Ph. La. m. A. T. Hill and lived in Texas. The families of James Moore Powell, John Hill, Dr. John Traylor, John Daniel Thomas, and others came to "Alabama Landing on Ouchita River in Union Parish, La. ca 1839-40 and settled the town of Marion, La. About 1857-58 the Powells moved to Walker Co. Texas. Probably operated saw mill or cotton gin. Need information & will exchange data. Mrs. Routh Whitley Benbow, 2616 NW 24th St., Fort Worth, Texas 76106

CLAUNCH-CARTER: Wiley Truehart Claunch b. 1822 in Ala. moved to Caldwell Ph. La. by 1860. Richmond, O. P., Taylor and William L. Claunch enlisted in CSA from Caldwell Ph. Joseph Claunch m. Anna Carter in St.Clair Co. Ala. St. Clair census 1830-50, Titus Co. Texas 1860-70, Johnson Co. Texas 1880. His children were: Andrew J. b. 1829; Sarah b. 1830; Celia b. 1832 m. Reuben Arnold Claunch; Wade H. b. 1834 m. Mary E. Claunch; Margaret b. 1838; Mary A. b. 1840; Berry T. b. 1842.

ROBERTS-LYONS-MOORE-SUMRALL-PHILLIPS-CLAUD: Josiah Roberts b. 1804 N.C. d. by 1872 m. (1) Martha -?- and (2) Aug 1867 Sallie Williams. Children by 1st wife: Cynthia Ann b. 1839 m. Matichi Lyons; Nancy b. 1851 m. John Moore; John Alexander b. 1843 m. (1) Nancy E. Sumrall (2) Nettie Phillips; Elizabeth b. 1844 m. James Claud; George Washington b. 1847. This family lived in Jasper and Newton Co. Tex. Will appreciate any information on Claunch-Carter-Roberts, et al, & descendents. Mrs. J. E. Claunch, 5901 Clovis Court, Wautauga, Texas 76248.

ELKINS-POPE-CARUTH-ALLEN-GARRETT-LEWIS-JOHNSON-ALEXANDER-PRICE-CROWLEY-CHEATHAM: William Elkins left will in Oglethorpe, Ga. to children: Thomas who m. Ann Pope; Nancy m. a Caruth; Joseph m. Fannie Allen; Erwin m. Elizabeth Garrott dau. of James & Amelia (Cheatham) Garrott; Fanny m. Robert Lewis; James m. Diana Johnson. William's 2nd wife was Amelia (Cheatham) Garrott, widow of James Garrott. Need data on first wife, William's parents, on Amelia Cheatham, and also James Garrott who died ca 1812.

1840 census of Henry Co. Ga. shows Erwin & Elizabeth (Garrott) Elkins, four sons and two daughters. Those identified: James Garrett who m. Martha Alexander dau. of Hiram Alexander; Elizabeth m. Thomas Wayman Price; Joseph Pinkney m. Letha Crowley; Frank m. Elizabeth -?-. Need data on missing son and daughter whose initials may have been C.B.

1880 census Claiborne Parish La. shows Elizabeth, age 80 b. in Virginia, mother of James Garrett Elkins. Other family lines: GAMBLE, MILLER, ROGERS, SNELL, VAN PELT, MANESS and AUTRY. Have some information on all and will exchange. Tom Elkins, P.O. Box 248, Robeline, La. 71469.

BUMGARDNER-THOMPSON-HOLLEY-HODGES-HOUSTON-LOCKEY-FOX-SMITH: Need parents, brothers, sisters, other data on Jacob Frederick Bumgardner b. 22 Jul 1810 Arlington, Va. d. 22 Jul 1881 Belvue, Bossier Ph. La., a carpenter by trade, m. (1) Lucy -?- (need all data on Lucy). On 1850 census Talledega, Ala. with two sons Jacob A. age 2 and George age 1. Lucy and George died, presumably in Talledega - need dates and burial place. Jacob A. Bumgardner m. (2) 7 Apr 1856 Mary or Martha Janie

- Cont'd -

Thompson in Talledega, Ala. and moved to Bossier Parish La. soon after 1860. They had: Ella or Ellen J. m. 21 Aug 1876 J. W. Houston; Walker R. m. (1) 3 Mar 1881 Juniel Lockey and (2) 13 Oct 1895 Mattie Fox; Lewis Roland m. 28 Mar 1885 Caroline Holley (Sister of Alwilda Keturah Holley); and Samuel F. m. Carrie Smith.

Jacob Alexander Bumgardner, Sr., son of Jacob F. & Lucy Bumgardner, b. 15 Dec 1847 in Alabama d. 16 Mar 1825 Bossier Ph. La. m. (1) June 1880 Alwilda Keturah "Kittie" Holley dau. of Nathan Holley and his 1st wife. Jacob A. m. (2) Sarah Hodges. Need dates, etc. on 1st wife and origin of name Alwilda.

Mrs. Alwilda B. Elkins, P. O. Box 248, Robeline, La. 71469.

LIGGIN-PRIMM-LAWRENCE-HUFFMAN-RUGG: James G. Liggin b. ca 1789 in Va. moved to Ga. as a child, m. Elizabeth -?- in Ga. where several children were born. On Perry Co. Ala. census 1830-1840, moved to Koscuisko, Miss. then to Union (now Lincoln) Ph. La. before 1850 census & died there 27 Jan 1871. Succession lists children: Mahala F. m. in Perry Co. Ala 15 Aug 1836 Nathan A. Primm moved to Union Co. Ark. before 1850 census and died before 27 Jan 1871; Narcissa E. b. ca 1831 in Alabama m. Charles R. Lawrence in Union Ph. La. and lived in Texas in 1871 but 1860 still in Union Ph. La. with children: P.O., age 8, Allen age 4, Richard age 2, Fanny age 6; Amanda S. m. ca 1846 Russell Huffman who was b. 1815-20 & moved from Koscuisko Miss. to Union Ph. La. before 1850

James Nathaniel Huffman m. 19 Sep 1881 Alice A. Rugg in Lincoln Ph. La., moved to Winnfield, La. and died there, had several children, some still living.

Want to contact descendents of Nathan A. & Mahala F. (Liggin) Primm; Charles R. & Narcissa E. (Liggin) Lawrence; James N. & Alice A. (Rugg) Huffman. Who were the parents of Russell Huffman? Have much data, need more and will exchange.

Mrs. Willie A. Farley, 2602 Stonewall St., Shreveport, La. 71103.

LEVERETT-CARGILL-CAGLE-GANDY-GREER-WORTHINGTON: Martin Woodson Leverett in Claiborne & Bienville Ph. La. between 1850-65. Married names of daughters: Sarah Cagle, Della Gandy, Rachel Frances Cargill, Mattie Virginia Greer. Want to correspond and exchange information with descendents of these daughters.

Also need Canadian records on Dr. Addison Worthington, lived Matilda Ontario 1841, Iroquois, Ontario 1851 and died Clinton, Ontario 1895. Need help to prove (or disprove) he was son of Stephen Worthington of West Springfield, Mass.

Mrs. Charles E. Friemel, 3608 Darien, Shreveport, La. 71109.

FULLER-JACKSON-BRITTON: Seaborn J. Fuller b. 20 May 1816 m. N. E. Jackson possibly 1st cousin of Stonewall Jackson. 1840 census Perry Co. Ala. shows two sons, one probably John Nokes Fuller b. 27 Sep 1836 m. Mary Ann Britton and enlisted CSA in Monroe, La. May 1862. Seaborn J. Fuller moved to Logan Co. Ark. ca 1870 and died there 30 Dec 1883. Deed shows N.E. Fuller wife of S. J. Fuller 1880. Need her full name, etc. Mary Ann (Britton) Fuller died 16 Feb 1916. In 1918 John Nokes Fuller moved with son James Thomas Fuller to Haskell Co. Okla. & died 22 Aug 1919. Who was Britain Fuller who married Nancy Jackson 29 Feb 1780 in Henry Co. Va.? Will appreciate any data and exchange information.

Mrs. William G. Fulton, 5394 East 26th St., Tulsa, Okla. 74114.

ROBERTSON-BOWMAN-SLEDGE-GRIFFIN-WARREN: Jeffery Robertson b. Scotland d. 1834 in Henrico Co. Va. m. Elizabeth Bowman. Daniel Sayers Robertson m. Lucretia Hamlet Sledge 29 Jan 1820 in Georgia. Was Jeffery Robertson descendent of Malcolm, son of Duncan of Scotland who was killed by Hamlet in 1040? Will exchange data.

Bird (Byrd) Griffin b. 1852 in Ireland d. 1916 Bussey, Ark. m. Rebecca Warren of Buckner Ark. who d. 1930 Taylor, Ark. Eight children: James, Newton, Jennie, Ocie, John, Paul, Alice, Ada, Lizzie. Need information on this family.

Mrs. James A. Griffin, Box 247, Springhill, La. 71075.

HALL-ALLUMS-GIDDINS-EATON-HICKS-BINGHAM: Need dates, parents, etc. on Eliza E. Allums b. 2 Dec 1835 in Ala. d. 2 Nov 1905 in La., parents b. in Georgia. Eliza m. 19 Dec 1860 Henry Jernigan Hall in La. witnessed by Floyd Allums. Was Floyd her father or her brother? Her sister, Prudence Allums m. Jacob Giddins. James Vale Hall b. ca 1840 m. Jane Bingham in Ohio, lived in Virginia & Indiana, moved to Vis-alia, Calif in 1874. Seymor Hall b. ca 1860 m. Sarah Elizabeth Eaton. 1860 Census Ashley Co. Ark. shows Thomas Hicks & wife Elizabeth b. in Ga., and with them N. D. (E ?) Hicks b. 1833 Ga., Ann Hicks b. 1836 Ala. and E. D. Hicks (female) b. 1858 in Ark. What kin were N. D., Ann & E. D. to Thomas & Elizabeth Hicks? Any help on these families will be appreciated.
Mrs. Vernon Honley, 612 W. 73rd St., Shreveport, La. 71106.

HUCKABAY-DENSON-WALLER-WOOLEY: Green Hillier Huckabay b. 23 Dec 1818 d. 1 Sep 1902 in La. m. 1837 in Georgia Deliah Ann Denson, their children: James P. Huckabay b. 20 Apr 1842 d. 1 Sep 1912-14; Sarah G. b. 6 May 1856 in La. m. Masalene Wooley and moved to Texas. Want to contact descendents, need James P.'s full name and other data. Also on Martha E. Huckabay who m. 10 May 1849 Ezekyl Waller in Stewart Co. Ga.; and Millie Huckabay b. 6 Dec 1867 d. New Mexico, dau. of William Bryant Huckabay - husband's name, children, date & place of death needed.
Ben M. Huckabay, Jr., 505 N. E. "F" Street, Antlers, Okla. 74523.

GRAVES-HUGHS-JONES-LEWIS: Samuel Graves b. 1802 in Georgia moved to Miss. and to Minden, Webster Ph. La. by 1850, his sons were Benjamin B. and Samuel Graves. Need name of wife, their parents, dates, residence in Georgia and Miss. Benjamin B. Graves b. 1821 in Miss. m. Martha Catherine Hughs and lived Webster Ph, La. 1850. Martha died by 1853. Their children: Samuel M. b. 1843; John N. b. 1844; Thomas P. b. 1846; Mary S. b. 1849 - all born in Louisiana. Want to correspond with any descendents of this family.

Washington Jones b. 1785 in Ala. (?) m. Fannie Lewis who died by 1870, on census Bienville Parish, La. 1870 as a physcian, age 85. Probably came to La. ca 1850. Sons: Dr. A. P. (Chill) Jones b. 1829 Ala., in Ringgold, La. 1870; Dr. Frank N. Jones b. 1835 in Ala. in Claiborne or Bienville Ph. La. 1870. Was Washington Jones full name Geroge Washington Jones? Where did he live in Alabama? Any relatives still living in Alabama? Will appreciate any information and will exchange.
Mrs. Robert L. Jones, 10906 Long Shadow Lane, Houston, Texas 77024.

KIZER-LANE-BROOM-ANDREWS-HUBBAFD-ROACH: Randolph Lane b. ca 1803 in Virginia m. ca. 1830 in Tenn. Wife probably died before 1850. Five children born in Tenn. moved to Madison Co. Mo. 1840-41, children born in Mo. were: Catherine & Tabitha (twins) b. 1842; Mose b. 1844. Catherine m. 1867 Francis Marion Kizer in Randolph Co. Ark. No record on Tabitha.

Wm. Thomas Broom b. in S.C. m. (1) 8 Jul 1875 Mary Ann Roach in Randolph Co. Ark, m. (2) 1893 Mary Andrews, and died 5 Apr 1911 in Hamil, Ark. Need parents of Wm. T. Broom and other data on family. Also, on Wm. Frank Roach b. 1810-15 in Kentucky m. ca 1837 Lucinda Hubbard in Ala. (One census lists her Amanda, another Lucinda). Wm. Frank Roach d. 1898 in Thayer Co. Mo. buried Roach Cemetery, Pocahontas, Ark. Need dates for death of wives and other data.

Mrs. A. G. Kizer, 2105 West Ave., Fullerton, Calif. 92633.

NUTTING-PRICE-BRISCOE-JACK-LEE: James H. Nutting m. ca 1875 Grayson Co. Texas Lizzie Price who was b. ca 1855 Natchitoches Ph. La. Their children: Bertha m. Henry Briscoe employee of Weather Bureau Washington D.C.; triplets Gilbert and Miller d. 1 yr. old and Thurmon; twins Essie & Rufus; Frank a CPA in Dallas 1926. Walter Jack m. ca 1862 Grayson Co. Tex. Mattie Price dau. of Alfred and Alice(Lee) Price, lived Ft. Worth, daughters: Edna, Ethel, Johnnie, Jessie; son: Ernest Jack. Want to locate descendents of all these families and exchange information.
Mrs. Leora J. Bishop, Rt. 7, Box 244-D, Oklahoma City, Okla. 73109.

WALKER-HUTCHINSON-HEARNE-GRAHAM: Rev. Joseph Walker, Methodist Minister, traveled Cahaba Circuit in Alabama (Dallas-Wilcox & adjoining Counties) and lived in Montevallo, Ala. in 1819. Lived in Tenn. before moving to Alabama and in 1829 he deeded 244 acres in Haywood Co. Tenn. to son-in-law John B. Hutchinson. Need parents, dates, name and records of wife. His Children were: Matilda b. 31 Dec 1808 in Tenn. d. 3 Aug 1847 m. 25 Jan 1826 John B. Hutchinson in Dallas Co. Alabama; Robert Lucky also Methodist Minister in Ala. later lived in Mobile and New Orleans and was a cotton factor; Mary b. 1800 d. 1858 buried Camden, Ala. m. Rev. Ebenezer Hearne, Presiding Methodist Elder in Ala.; Isphena m. Joseph Graham and moved to near Rocky Mount, Bossier Parish, La. The Rev. Joseph Walker of Alabama and Tenn. was a cousin of Rev. Joseph B. Walker who died in New Orleans in 1897. Will be glad to exchange data on this family and will appreciate any help.
Mrs. W. C. McClellan, 615 Ontario St., Shreveport, La. 71106.

MIMS-SANDERS: Ephriam Sanders b. 14 Mar 1760 d. Nov 1796 in Columbus Co. Ga. m. 19 Dec 1788 (where ?) Ann "Nancy" Sanders b. 20 Nov 1761 d. 7 Aug 1798. on 16 May 1797 Nancy Sanders deeded the personal estate of Ephriam Sanders to these children: Billington McCarthy Sanders; Betsy Hubbard Sanders who m. 27 Jun 1809 Seaborn Mims in Columbia Co. Ga.; Dennis Downman Sanders. Have data to exchange on first two but none on Dennis except this: Seaborn Mims' dau. Nancy Elmira (Mims) Baker wrote a letter in 1873 stating that 'Uncle Dennis Sanders had two daughters in Mansfield, La. in the summer of 1873, when she visited in Mansfield. I am interested in data on this Sanders family.
Miss Ann Mellard, Rt. 1, Box 113-A, Williford, Ark. 72482.

BRADFORD, et al: Am trying to locate descendants of WILLIAM MALAKIAH BRADFORD b. 1787 in S.C. d. Bastrop, La. 1869 m. 4 Apr 1818 ANGELINA REAMS b. 1802 in Ethel, La. d. 1835 E. Feliciana Parish, La. They had five children all born Port Hudson East Feliciana Parish, La.

1. NANCY L. (ANN) BRADFORD b. 1819 d. 1888 Bastrop, La. m. SAMUEL WINWATER CARNEY moved to Bastrop ca 1858 and had five children: Malakiah Bradford Carney m. Georgia Eubanks and had Percy, Linton Bradford, Warren, Ovid L. and Cas. Sarah Ann Carney m. Joseph W. Mc Cormick and had Mary Ira who m. G. W. Jordan and lived near Baton Rouge, Alms, and Sarah (Sallie). Mary Elizabeth Carney m. Benjamin Kendrick Vaughan and only one child John Benjamin Vaughan lived to adulthood. He reared his family of five in Greenwood, La. - Hattie Ruth Vaughan m. Ben Roberts; Lillian m. O. H. Box; Floris m. D'Arsey Simpson; Mary m. Gilbert Hudson; & John Benard Vaughan. John P. Carney and Robert H. Carney evidently died young.

2. ELIZA BRADFORD b. 1822 death date unknown m. 1840 WILLIAM M. TAYLOR. On 1860 census E. Baton Rouge Ph., La. with three children: Margaret age 19, Amos age 17 and Zachariah age 13. No other data on this family.

3. SARAH ANGELINA BRADFORD b. 1823 d. 1851 m. 1844 JAMES H. COLEMAN who also died in 1851. Had one dau. Angelina b. 1845 who was reared by her grandfather William Malakiah Bradford. He died at her home in Bastrop in 1869. Angelina Coleman m. Benjamin Ware Sewell and had two children: a son (name unknown) was in Albuquerque New Mexico in 1936; and a dau. Sarah who m. a Roberts and had Wilhemina who m. H. V. Sherrill, living in Long Beach, Miss in 1937.

4. HENRY O. BRADFORD who evidently died young.

5. MALAKIAH WILLIAM BRADFORD b. 1832 d. 1900 m. 1840 MARY ROSE MANSFIELD and had six children: William Royal (Will) b. 1850 m. (1) Edna Woodley and had two children, May and Elbin. Will m. (2) Lula Hearne, had one dau. Frankie who m. George Gibbons and lived in Corpus Christi. Elizabeth Q. m. Thomas Vaughan and had Cloe, Jack, Loy, Camie Ray, T. M. and Creswell. Mary Francis b. 1860 d. 1935 m. Dr. F. L. Johnson and their children were Clara m. Jim Pat Flournoy, Mary m. a Robinson now living in Houston, Texas, Frank never married, and Claude died young. Charley Frost b. 1865 d. 1908 m. Addie Laura Evans and had one son Charles Frost (Jack).

- Cont'd next page -

BRADFORD - Malakiah William Bradford - Con'td.

Charlotte b. 1864 m. an Ellis (first name unknown) buried beside Charlotte & their child in Greenwood, La. cemetery. Sarah Brown b. 1869, m. Isham Thweatt and had Marie m. Albert Smith; Dulcie, Henry, Bradford, and Roger.

William Malakiah Bradford's children were reared in Greenwood, La. and some of their descendants are still in the area.

Mrs. Gwen Bradford Wardlaw, Box 555, Coushatta, La. 71019.

GOWAN-COSTLY-TOMLIN-DAILEY-REPON: Who were the parents of SUSAN GOWAN who was born ca 1780 in Georgia, married PIERCE COSTLY in Warren Co., Ga. in Nov 1800?

Who were parents of JASON TOMLIN born 1810 in So. Carolina and drew land in 1832 Georgia Land Lottery?

Can anyone help me identify OWEN DAILEY who married BARBARA REPON in Ouchita Parish, La. in 1832? Where was he from? Who was his first wife? Who his parents?

Mrs. K. W. Wright, Apt. J-103 Villa Del Lago, 3500 Milam St., Shreveport, La. 71109

HAYWOOD-STEVENSON-SINGLETON: Need parent and brothers & sisters of David Haywood b. ca 1812 in N.C. m. (when ?) Jeannette -?- b. ca 1820, lived in Carroll Co. Tenn. 1834 to ca 1857, moved to Independence Co. Ark. and on 1860-70-80 census there. Children all born in Tenn: Anne E. b. ca 1837 m. Elijah Neighbors; Harriet T. b. ca 1840 m. 1858 Wm. T. McCulloch in Independence Co. Ark.; Mary Jane b. 1842 m. John Riley Harris and moved to Missouri; Egbert M. b. ca 1843; Louisa G. b. ca 1845 m. T. W. Caraway in Ark.; David W. b. ca 1846 m. Matilda Tosh; Alexander P. m. Martha -?-; Sarah C. b. ca 1853 m. W. J. Rainey; Viola G. b. ca 1855; Henderson L. b. ca 1856; and

Edmond Raymond Haywood b. 27 May 1837 m. (1) Sarah Stevens in St. Francis Co., Mo. 1864. (Sarah dau. of John Stevens who moved from Virginia to Iron Co. Mo. by 1860.) Children of Edmond & Sarah (Stevens) Haywood: Francis b. 1865; Edward Grant b. 1868 m. Alma Copeland; Hattie J. b. 1871 m. John Riley Singleton who was b. 1849 Wayne Co. Mo. son of Micajah (Michael) and Elizabeth Singleton b. in Va./N.C. to Tenn. to Mo. by 1849. Children of Michael & Elizabeth Singleton were: Eli. A. b. c 1837; Amanda b. ca 1839; Jesse b. ca 1841; William b. ca 1843; Mary b. ca 1845; Lucinda b. 1847; (all these born in Tenn.). Children born in Missouri: John R. b. 1849; Nancy b. 1853; Willis b. 1854; James b. 1857; and Elizabeth b. 1864. Need and will exchange information on all of these.

Mrs. Maxine Sturdy, 14410 Pinney St., Arleta, Calif. 91331

MAINES-ALFORD-SEABURN: Jesse Maines will probated 1839 Washington Ph., La. Mary (Wade) Maines, natural Tutrix, Samuel F. Maines, under tutor. Children named were Francis Ruth, Mary Ann and Sarah, in succession. 1830 census Washington Ph. shows son age 5/10. Relationships to William Maines on Washington Parish 1830 census.

William Maines came to St. Tammany Ph. La. ca 1807 and married Lucy Alford, dau. of Jacob Alford and wife Frankey B. Seaburn also St. Tammany Ph., La. 1807. Sons of William & Lucy Maines: John b. 1831 Washington Ph.; Jacob b. 1833 Washington Ph. La. m. Liza Smith and had Ludie who m. an Allen, Bootnick and Richard who died young; Elbert R. Maines b. 1823 Washington Ph, La. m. 21 Dec 1848 Sabine Ph. La. Celia Richey & lived in Montgomery Co. Texas ca 1890. Luraney Maines b. ca 1815 in La. m. ca 1838 Noel Waddell & filed petition 3 Dec 1853 in estate of Noel in E. Feliciana Ph., La., mentions children Martha m. Henry Hammond 11 May 1872, Letha B. age 8-1850 census, Lucy age 3-1850 census m. P. Boyle 24 Nov 1872, Noella m. 10 Feb 1881 John N. Smith. Luraney Maines Waddell mentioned in William Maines will Sabine Parish, La. 1849. Who was Matthew Jones? Who was his wife? He was named in administration and settlement of William Maines's will in Sabine Ph. Was Matt husband of deceased daughter of William Maines? Mathew Jones may have lived in Natchitoches Parish. Will welcome help and exchange data on all these.

Mrs. Lucy S. Stevens, 803 Roxboro Road, Rockville, Maryland 20850.

PLEASE FILL OUT THE FOLLOWING FORM AND SEND IN WITH YOUR DUES FOR 1971, OR YOUR APPLICATION FOR MEMBERSHIP IN THE ARK-LA-TEX GENEALOGICAL ASSOCIATION.

MEMBERSHIP APPLICATION OR DUES REMITTANCE

ARK-LA-TEX GENEALOGICAL ASSOCIATION
P. O. Box 71
Shreveport, Louisiana
71102

Please Print or Type:

NAME Mr.
Mrs.
Miss _____
First Middle Maiden Last

ADDRESS: _____ Zip _____
City State

OCCUPATION: _____ TELEPHONE NO. _____

FAMILIES YOU ARE INTERESTED IN: _____

1971 Membership Fee: \$3.00 per Calendar Year, January 1 to December 31. Members receive four issues of THE GENIE each year. Queries published free.

Mail all dues and membership applications to P. O. Box 71, Shreveport, La. 71102

REGISTRATION FOR FIFTH ANNUAL WORKSHOP
ARK-LA-TEX GENEALOGICAL ASSOCIATION

Saturday, 15 May 1971
9:00 a.m. - 5:00 p.m.

Holiday Inn, Downtown Shreveport-Bossier City
I-20 at Hamilton Road, Bossier City, La.

MR. MILTON RUBINCAM, noted Genealogist, will lecture on "Pitfalls in Genealogical Research", "Evaluation of Genealogical Materials", related subjects, and qualifications of Certified Genealogists, American Lineage Specialists and Record Searchers. Full program details attached or in April GENIE. Registration Fee: \$6.00 per person. Mail Registration with check in time to be delivered by Thursday, 13 May 1971, to P. O. Box 71, Shreveport, La. 71102

NAME: _____

ADDRESS: _____
City State Zip

FAMILIES INTERESTED IN: _____

Enclose your check for \$6.00 and mail to ARK-LA-TEX-GENEALOGICAL ASSOCIATION
P.O. Box 71, Shreveport, La. 71102 in time to be received by Thursday, 13 May 1971.

FIFTH ANNUAL WORKSHOP
of the
ARK-LA-TEX GENEALOGICAL ASSOCIATION
Saturday, 15 May 1971
9:00 a.m. - 5:00 p.m.
BANQUET ROOM, HOLIDAY INN, DOWNTOWN
Shreveport-Bossier City
I-20 at Hamilton Road, Bossier City, La.

